

VER	DESCRIPTION OF REVISIONS	DATE
A-1		2016/02/19

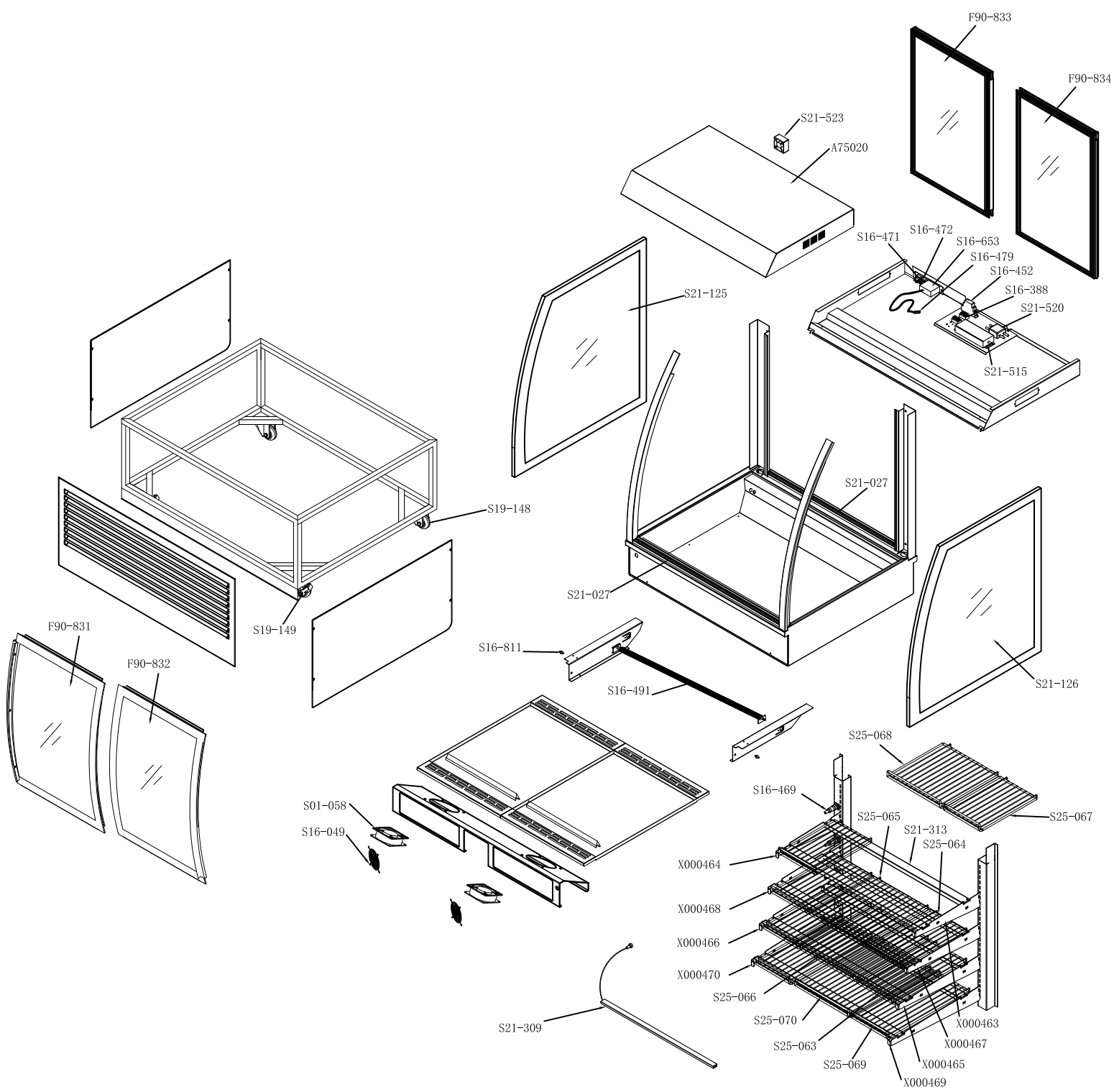

F90-106 D4HT9 Part List

Part No.	Name	Spec	QTY
A75020	Top cover		1
F90-831	Left Front Door Assy		1
F90-832	Right Front Door Assy		1
F90-833	Left Rear Door Assy		1
F90-834	Right Rear Door Assy		1
S01-058	Fan	EBM4656N	2
S16-049	Fan guard	120X120	2
S16-388	Terminal block	250VAC, 2.5MM2	2
S16-452	Circuit breaker	NCH8-20/20 AC230V 50~60HZ	1
S16-469	Connector, 3-PIN		3
S16-471	Power supply button	PEOPZSRG10 green	1
S16-472	Lamp button	PEOPZSRW10 white	1
S16-479	Sensor	NTCO15WP00-C4HT	1
S16-491	Heater	1500W/240V Φ8/Φ24X720MM	1
S16-653	Thermostat	PJEZSOP000	1
S16-811	Thermal Protector	KSD301 90°C	2
S19-148	Castor C/W Break	2.5"	2
S19-149	Castor	2.5"	2
S21-027	Door track		2
S21-125	Side glass-left		1
S21-126	Side glass-right		1
S21-309	LED light	L=700	4
S21-313	LED extrusion	L=787MM	8
S21-515	Water Proof Power Supply	LW100-0120833-BC00	1
S21-520	EMI Filter	HT170-10-L8-B3	1
S21-523	flow fan	SUNON EE60251B2-000C-999	1
S25-063	shelf	400X238	2
S25-064	shelf	360X238	2
S25-065	shelf	360X300	1
S25-066	shelf	400X300	1
S25-067	shelf	320X238	2
S25-068	shelf	320X300	1
S25-069	shelf	445X238	2
S25-070	shelf	445X300	1
X000463	crossbeam of shelf-right		1
X000464	crossbeam of shelf-left		1
X000465	crossbeam of shelf-right		1
X000466	crossbeam of shelf-left		1
X000467	crossbeam of shelf-right		1
X000468	crossbeam of shelf-left		1
X000469	crossbeam of shelf-right		1
X000470	crossbeam of shelf-left		1