

F93-009 BTGAB12 Part List

Part No	Name	Spec	QTY
AA61103	Top cover		1
F90-837	Left Rear Door Assy		1
F90-838	Right Rear Door Assy		1
S16-388	Terminal block	250VAC, 2.5MM2	2
S16-807	Plug	WS16J3TQ-C, WE1PU, 3P	3
S16-808	Socket	WS16K3Z-C, WE1PU, 3P	4
S16-871	Lamp button	Dixell CXL5 yellow	1
S16-888	Power supply	LRS-75-12, 12V/6A	1
S21-027	Door track		1
S21-293	LED light	L=1000	4
S21-314	LED extrusion	L=1087MM	8
S21-407	Top glass		1
S21-409	Front glass		1
S21-410	Side glass		2
S21-624	Adjustable Castor	2"	4
S21-826	Flow fan	SUNON EE60251B1-000C-999	1
S25-069	Shelf	445X238	8
S25-070	Shelf	445X300	8
X000469	Crossbeam of shelf-right		4
X000470	Crossbeam of shelf-left		4
F93-533	Left Front Door Assy		1
F93-534	Right Front Door Assy		1
AA61106	Front Door Track A		1
AA61107	Front Door Track B		2
AA61109	Side Glass Frame		1
S21-027	Door track		1

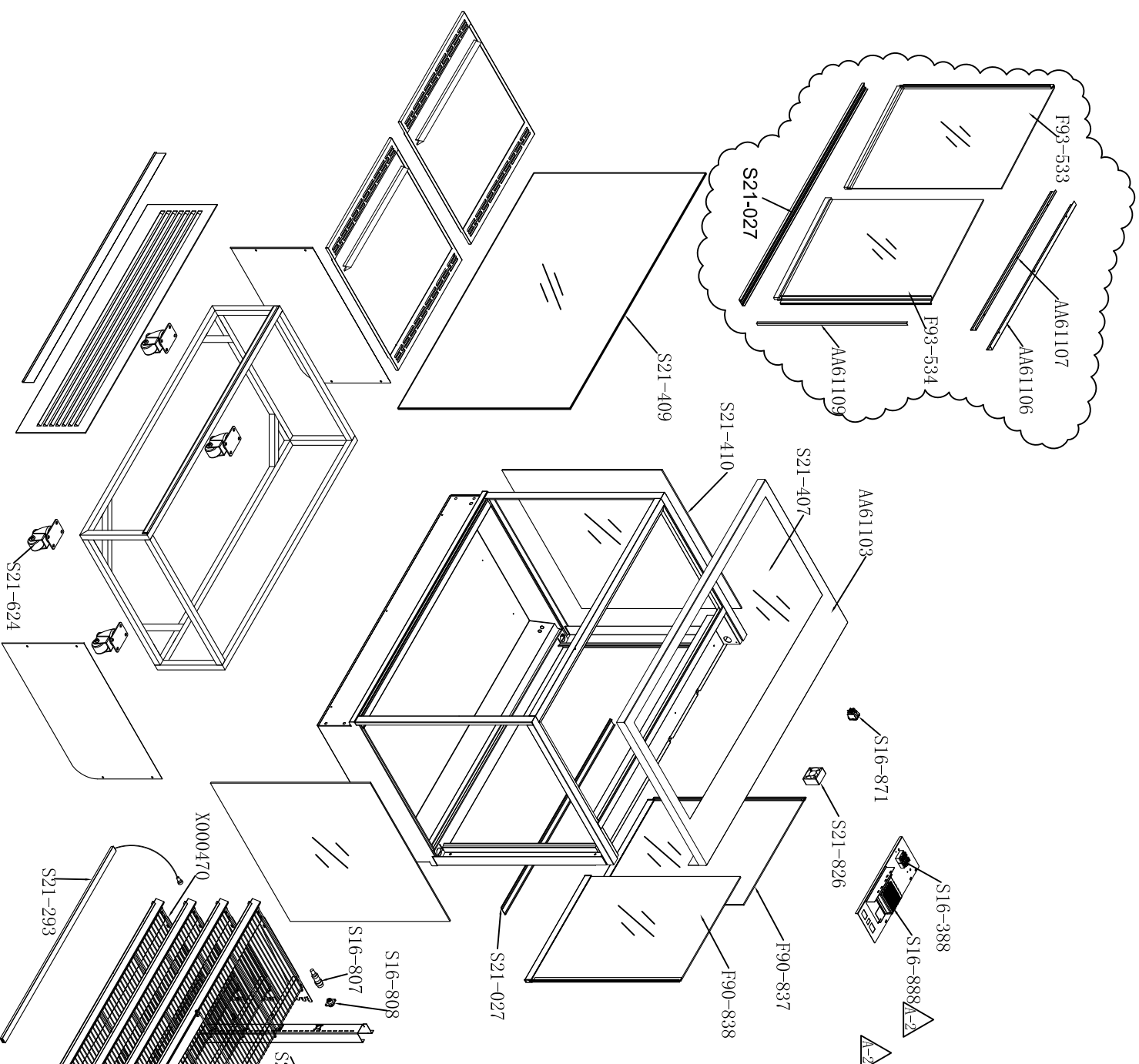

VER	DESCRIPTION OF REVISIONS	DATE
A-2	The Power Supply changes to S16-888	2019/11/29
A-1	Flow fan changes to S21-826	2019/01/23
A-0		2016/11/28