

VER	DESCRIPTION OF REVISIONS	DATE
A-0		2019/02/28
A-1	Power supply changes to S16-888 Isolate Circuit breaker S16-886	2020/01/13

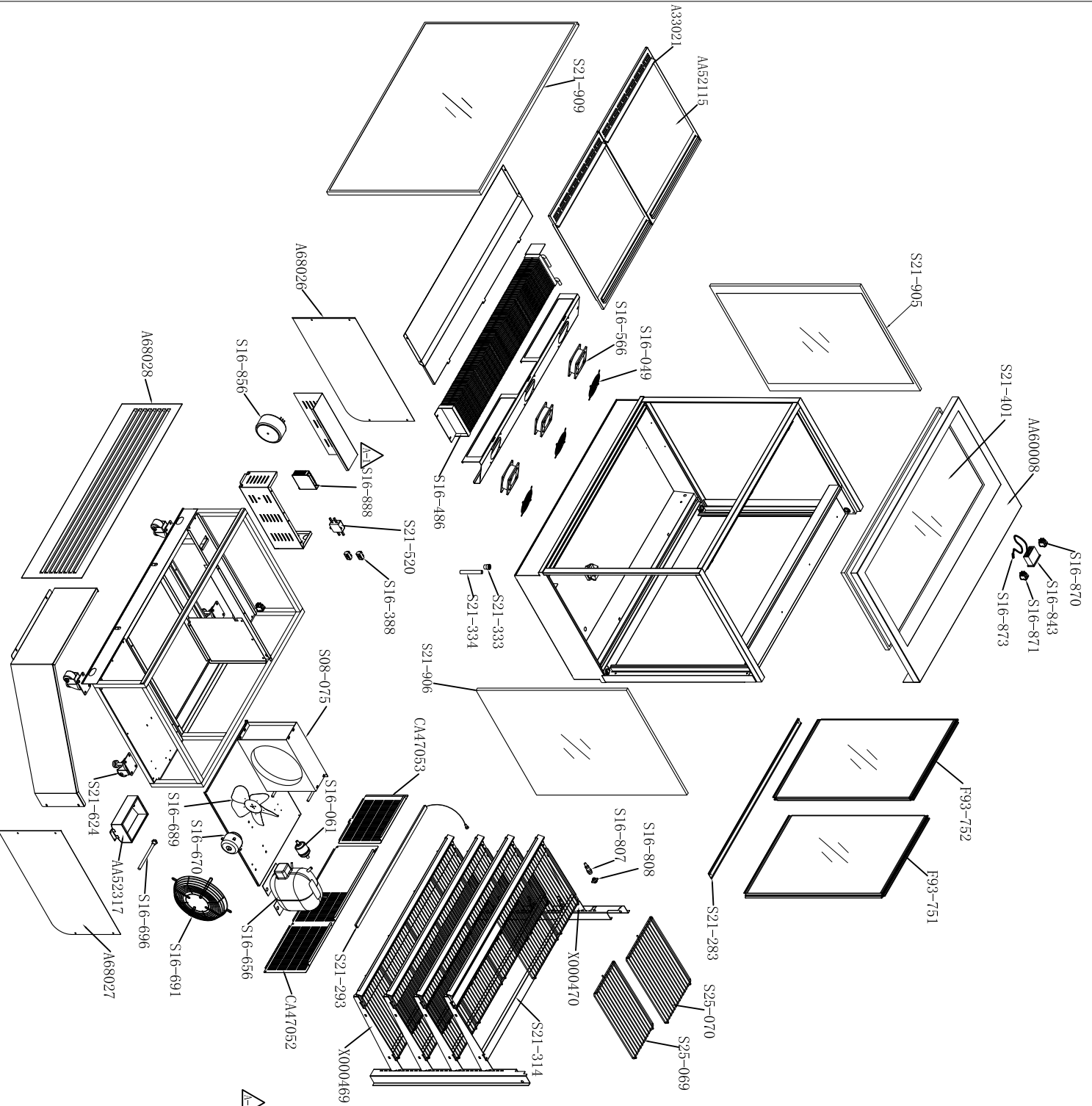

ID	Part No	Name	Spec	Unit	Qty	Note
1	A33021	Ticket strips of deck		PCS	2	
2	A68026	Left side cover		PCS	1	
3	A68027	Right side cover		PCS	1	
4	A68028	Front Shutter		PCS	1	
5	AA52317	Evaporating pan with heater		PCS	1	
6	CA47052	Rear cover		PCS	1	
7	AA52115	Deck trays		PCS	2	
8	CA47053	Rear cover-left		PCS	1	
9	AA60008	Top cover		PCS	1	
10	F93-751	Rear Sliding Door - Left		PCS	1	
11	F93-752	Rear Sliding Door - Right		PCS	1	
12	S08-075	Condenser	290	PCS	1	
13	S16-019	Fan guard	120X120	PCS	3	
14	S16-061	Filler	DM-635-3/8"	PCS	1	
15	S16-288	Terminal block	250VAC, 2.5MM2	PCS	2	
16	S16-886	Circuit breaker	10T 120 220 240 25A	PCS	1	
17	S16-686	Evaporator	0.1. 90X139X1080 (12.7MM)	PCS	1	
18	S16-686	Fan	SHENG KMJ-SM108W-22-1	PCS	3	
19	S16-636	Compressor	SIJCOM-8C21C R134A	PCS	1	
20	S16-670	Fan motor	SP-BHEHME(LHW)	PCS	1	
21	S16-689	Fan blade	PY100CKRNS50	PCS	1	
22	S16-691	Fan housing of motor	ø290-50	PCS	1	
23	S16-696	Heater	190W	PCS	1	
24	S16-607	Plug	MS161310-C, WEPLU_3P	PCS	4	
25	S16-808	Socket	MS16832-C, WEPLU_3P	PCS	4	
26	S16-843	Thermostat	MS1611 X006CK550C1 240V/50HZ	PCS	1	
27	S16-856	Transformer	KL120-0100-1-01 210-48V	PCS	1	
28	S16-870	Power supply button	Dixell CXL5 green	PCS	1	
29	S16-871	Lamp button	Dixell CXL5 yellow	PCS	1	
30	S16-873	Sensor	Dixell N06 3M	PCS	1	
31	S21-283	Door track		PCS	1	
32	S21-293	LED Light	1=1000	PCS	5	
33	S21-314	LED extrusion	1=1087MM	PCS	8	
34	S21-333	Complid pipe	20X1/2"	PCS	1	
35	S21-334	PVC pipe	Ø20	PCS	0.05	
36	S21-401	Top glass		PCS	1	
37	S21-520	DM Filler	HL170-10-18-08	PCS	1	
38	S21-624	Adjustable Castor	2"	PCS	4	
39	S16-888	Power supply	1RS-75-12, 12V/6A	PCS	1	
40	S21-905	side glass-right		PCS	1	
41	S21-906	side glass-left		PCS	1	
42	S21-909	Front glass		PCS	1	
43	S25-069	shelf	448X238	PCS	8	
44	S25-070	shelf	448X300	PCS	8	
45	X000469	crossbeam of shelf-right		PCS	8	
46	X000470	crossbeam of shelf-left		PCS	4	