

VER	DESCRIPTION OF REVISIONS	DATE
A-0	Power supply changes to S16-888	2019/02/28
A-1	Replace circuit breaker S16-888	2020/01/13

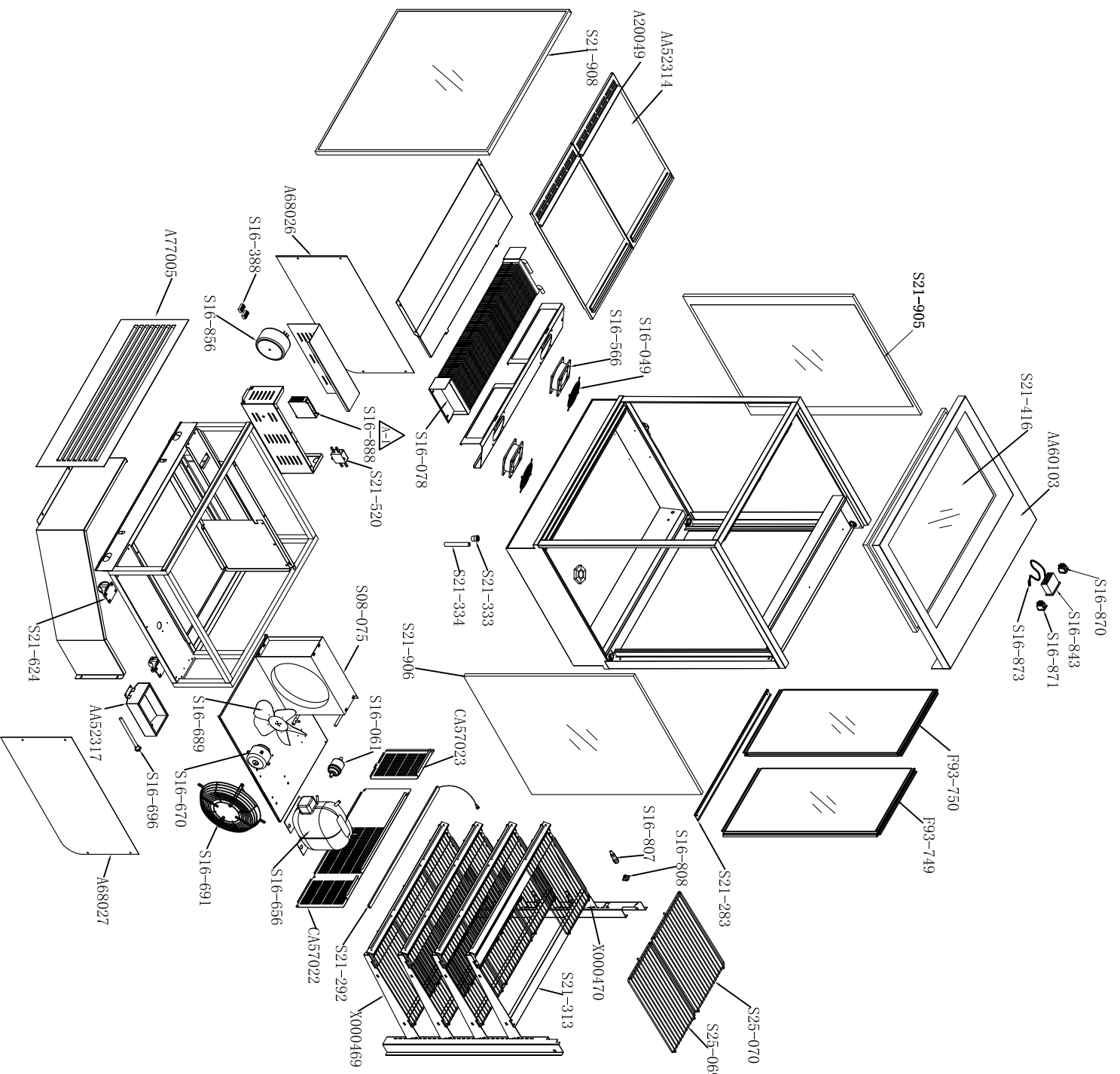

No	Part No	Name	Spec	Unit	Qty	Note
1	A20049	Tickler strips of deck		PCS	2	
2	A68026	Left side cover		PCS	1	
3	A68027	Right side cover		PCS	1	
4	A77005	Front Shutter		PCS	1	
5	AA52317	Evaporating pan with heater		PCS	1	
6	CA57022	Rear cover		PCS	1	
7	CA57023	Rear cover-left		PCS	1	
8	AA52314	Deck trays		PCS	2	
9	AA60103	Top cover		PCS	1	
10	F93-749	Rear Sliding Door - Left		PCS	1	
11	F93-750	Rear Sliding Door - Right		PCS	1	
12	S08-075	Condenser	290	PCS	1	
13	S16-049	Fan panel	120X120	PCS	2	
14	S16-061	Filliter	DM-4635-3/8"	PCS	1	
15	S16-078	Evaporator	O.D. 90X193X76 (12.700)	PCS	1	
16	S16-288	Terminal block	250VAC, 2.5MM2	PCS	2	
17	S16-566	Fan	SHENG HENG-SHU090-22-1	PCS	1	
18	S16-666	Compressor	SECCO-SC216-R134A	PCS	1	
19	S16-670	Fan motor	SP-1818HE2(180)	PCS	1	
20	S16-689	Fan blade	PY100C30S50	PCS	1	
21	S16-691	Fan housing of motor	φ280-80	PCS	1	
22	S16-696	Heater	150W	PCS	1	
23	S16-807	Plug	KS161317C-C, WEIPL, 3P	PCS	4	
24	S16-808	Socket	WS16R32-C, WEIPL, 3P	PCS	4	
25	S16-843	Thermostat	Dixell1 X806C-SNOC1	PCS	1	
26	S16-856	Transformer	K1120-400-1-01, 240V-48V	PCS	1	
27	S16-870	Power supply button	Dixell1 CUS green	PCS	1	
28	S16-871	Lamp button	Dixell1 CUS yellow	PCS	1	
29	S16-873	Sensor	Dixell1 N06 3M	PCS	1	
30	S16-888	Power supply	LRS-75-12, 12V/6A	PCS	1	
31	S21-283	door track		PCS	1	
32	S21-292	LED Light	1-7500	PCS	5	
33	S21-313	LED extension	1-670M	PCS	8	
34	S21-333	Comoilng pipe	20X1/2"	PCS	1	
35	S21-334	pvc pipe	D620	PCS	0.05	
36	S21-416	Top glass		PCS	1	
37	S21-520	DM Filter	H1710-10-4-8-83	PCS	1	
38	S21-624	Adjustable Castor	2"	PCS	4	
39	S21-905	side glass-left		PCS	1	
40	S21-906	side glass-right		PCS	1	
41	S21-908	Front glass		PCS	1	
42	S25-069	sheet	445X228	PCS	8	
43	S25-070	sheet	445X300	PCS	4	
44	X000469	crossbeam of shel-left		PCS	4	
45	X000470	crossbeam of shel-right		PCS	4	

Cossetta F93-111 TTGRP9