

VER	DESCRIPTION OF REVISIONS	DATE
A-0		2016/12/20
A-1	The digital thermostat changes to S16-876	2017/11/15
A-2	Circuit breaker changes to S16-896 Flow fan changes to S21-826	2018/11/15
A-3	Fan changes to S16-916 Power Supply to S16-888	2020/01/13

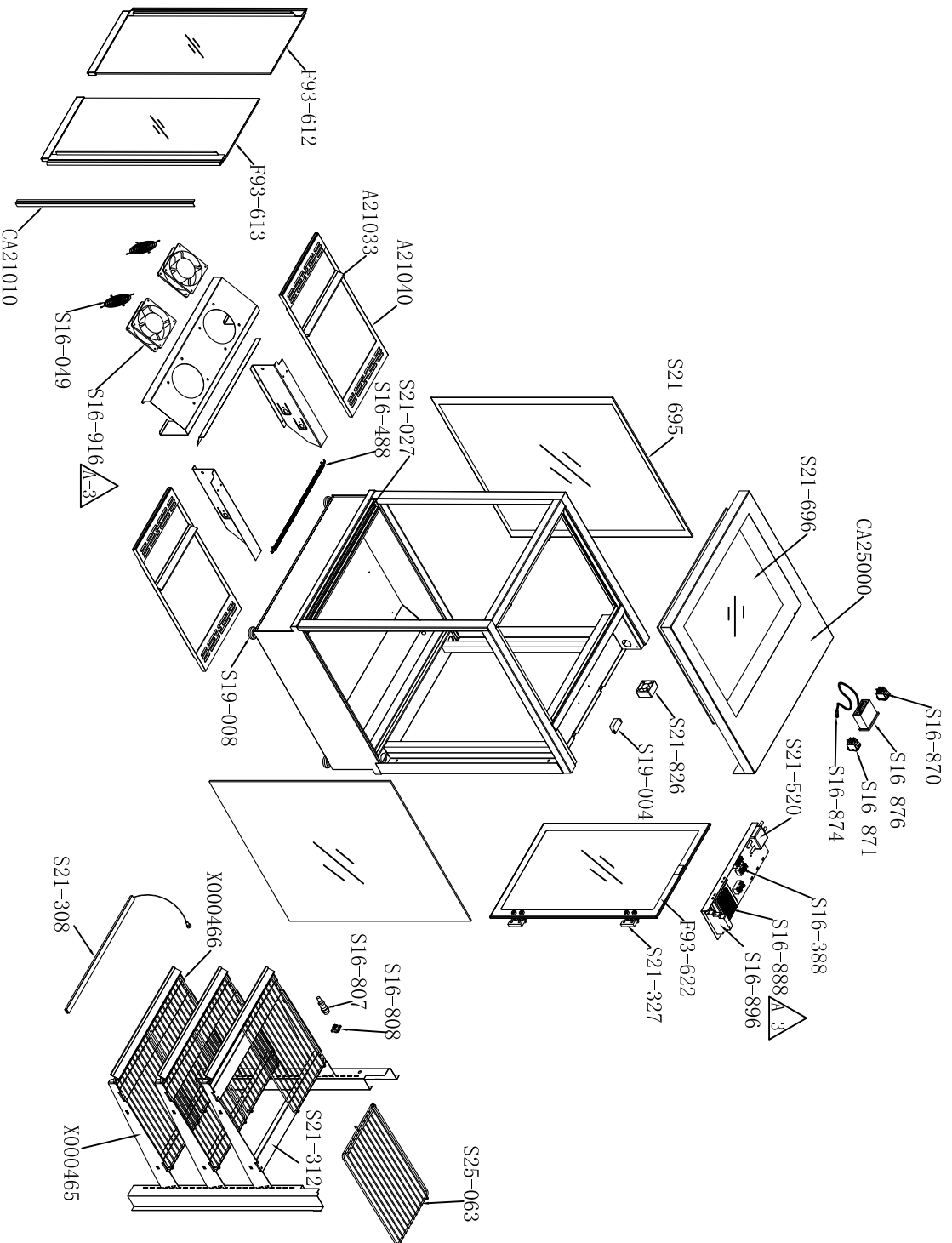

Cossiga F93-040 STGHT6

Part No.	Name	Spec	Qty
CA25000	Top cover		1
A21040	Deck trays		2
A21033	Deck strips of deck		2
S21-695	Fan guard	120X120	2
S21-696	Terminal block	250VAC, 2.5MM2	3
S21-520	Heater	1000W/240VΦ8/Φ24X420MM	1
S21-826	Plug	WS16J31Q-C, WE1PU, 3P	2
S19-004	Socket	WS16K3Z-C, WE1PU, 3P	3
S16-870	Power supply button	Dixell CXL5 green	1
S16-871	Lamp button	Dixell CXL5 yellow	1
S16-874	Sensor	Dixell NS65 1.5M BN11080150	1
S16-876	Thermostat	Dixell XR02CX 240V/50HZ	1
S16-888	Power Supply	LRS-75-12, 12V/6A	1
S16-896	Circuit breaker	ICT 1N0 230°240V 25A	1
S16-916	Fan	FULLTEC UP-12AM238THH	2
S19-004	Magnet		1
S19-008	plastic footling	M10*55	4
S21-027	Door track		1
S21-308	LED light	L=400	1
S21-312	LED extrusion	L=487MM	3
S21-327	Hinge	50X50MM	6
S21-696	Top glass		2
S21-695	Side glass		1
S21-520	EMF Filter	HT170-10-1.8-1B3	1
S21-826	Flow fan	SINON EF60251B1-000C-999	1
S25-063	Shelf	400X238	6
X000465	Crossbeam of shell-Right		3
X000466	Crossbeam of shell-Left		3
F93-612	Left Front Door Assy		1
F93-613	Right Front Door Assy		1
CA21010	Side Glass Frame		1
F93-622	Rear Door Assy		1