

VER	DESCRIPTION OF REVISIONS	DATE
-----	--------------------------	------

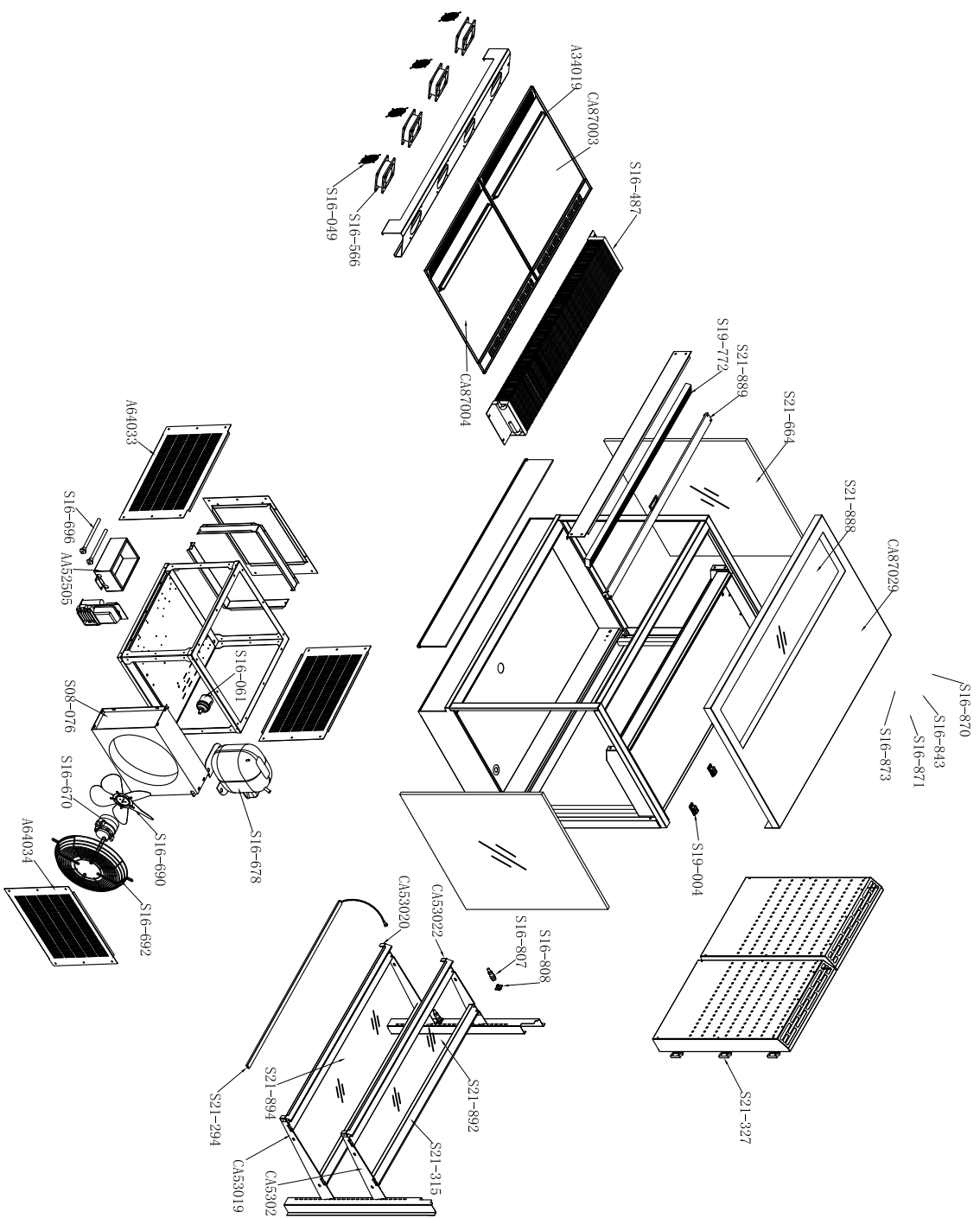

Cossiga P93-106 BTGR15D1

ID	Part No.	Name	Spec	Unit	Qty	Note
1	A34019	Ticket strips of deck		PCS	2	
2	A64034	The condenser rear seal		PCS	1	
3	A64033	The condenser side seal		PCS	2	
4	AA52505	Evaporating pan with heater		PCS	1	
5	CA87029	Top cover		PCS	1	
6	CA87003	Deck trays-left		PCS	1	
7	CA87004	Deck trays-right		PCS	1	
8	S08-076	Condenser	330	PCS	1	
9	S16-049	Fan guard	120X120	PCS	4	
10	S16-061	Filter	DM-603S-0.8"	PCS	1	
11	S16-487	Evaporator	0. D. 90X195X13809 (12.7mm)	PCS	1	
12	S16-566	Fan	SHENG. (MFL-SM100AF-22-1	PCS	4	
13	S16-670	Fan motor	SP-B1616H2E2(16V)	PCS	1	
14	S16-678	Compressor	SR00- G526MFX R134A	PCS	1	
15	S16-690	Fan blade	FV120C930583	PCS	1	
16	S16-692	Fan housing of motor	Φ320-80	PCS	1	
17	S16-696	Plug	190W	PCS	2	
18	S16-808	Socket	WS16RZ-C. WE1PL. 3P	PCS	2	
19	S16-808	Thermostat	Dixell 3P	PCS	3	
20	S16-843	Power supply button	Dixell 110V-240V/30W	PCS	1	
21	S16-870	Lamp button	Dixell 110V-240V/30W	PCS	1	
22	S16-871	Sensor	Dixell 110V-240V/30W	PCS	1	
23	S16-873	Magnet	Dixell 110V-240V/30W	PCS	1	
24	S19-004	Magnet	Dixell 110V-240V/30W	PCS	2	
25	S19-772	Homocomb Wind deflector		PCS	1	
26	S21-294	LED light	L=1800	PCS	4	
27	S21-315	LED extension	L=1870MM	PCS	4	
28	S21-327	Hinge	50X50MM	PCS	6	
29	S21-889	Night blind		PCS	1	
30	S21-884	Side glass		PCS	2	
31	S21-888	Top glass		PCS	1	
32	S21-892	Glass of shelf (top)		PCS	1	
33	S21-894	Glass of shelf (bottom)		PCS	1	
34	CA53021	Crossbeam of shelf-right		PCS	1	
35	CA53022	Crossbeam of shelf-left		PCS	1	
36	CA53019	Crossbeam of shelf-right		PCS	1	
37	CA53020	Crossbeam of shelf-left		PCS	1	