

VER	DESCRIPTION OF REVISIONS	DATE
A-0		2018/06/08

**F93-101 STGOH9 Part List**

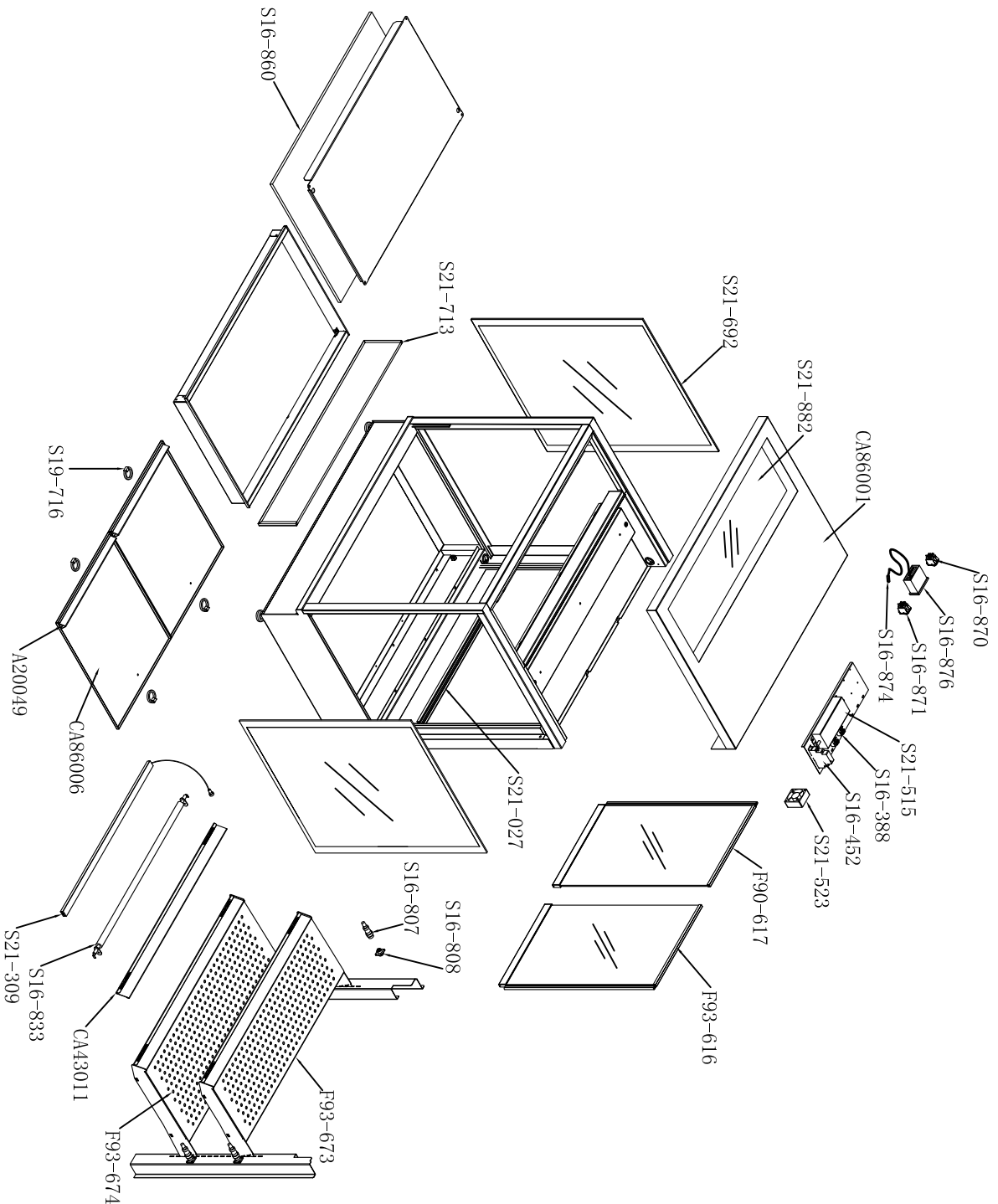

ID	Part No.	Name	Spec	QTY
1	A20049	Ticket strips of deck		2
2	CA43011	advertising board		2
3	CA86001	Top cover		1
4	CA86006	Deck trays		2
5	S16-388	Terminal block	250VAC, 2.5MM2	2
6	S16-452	Circuit breaker	NCH8-20/20 AC230V 50~60HZ	1
7	S16-807	Plug	WS16J3TQ-C, WE1PU, 3P	4
8	S16-808	Socket	WS16K3Z-C, WE1PU, 3P	4
9	S16-833	Heater	400W/230VAC	4
10	S16-860	Foil heater	350W/230V	1
11	S16-870	Power supply button	Dixell CXLs green	1
12	S16-871	Lamp button	Dixell CXLs yellow	1
13	S16-874	Sensor	Dixell NS6S 1.5M BN11080150	1
14	S16-876	Thermostat	Dixell XR02CX 240V/50HZ	1
15	S19-716	Pull ring		4
16	S21-027	Door track		1
17	S21-309	LED light	L=700	4
18	S21-515	Water Proof Power Supply	LW100-0120833-BC00	1
19	S21-523	Flow fan	SUNON EF60251B2-000C-999	1
20	S21-692	Side glass		2
21	S21-713	Front glass		1
22	S21-882	Top glass		1
23	F93-616	Left Rear Door Assy		1
24	F90-617	Right Rear Door Assy		1
25	F93-673	Shelf(top)		1
26	F93-674	Shelf(middle)		1