

VER	DESCRIPTION OF REVISIONS	DATE
A-0		2018/06/08

F93-100 STGOH6 Part List

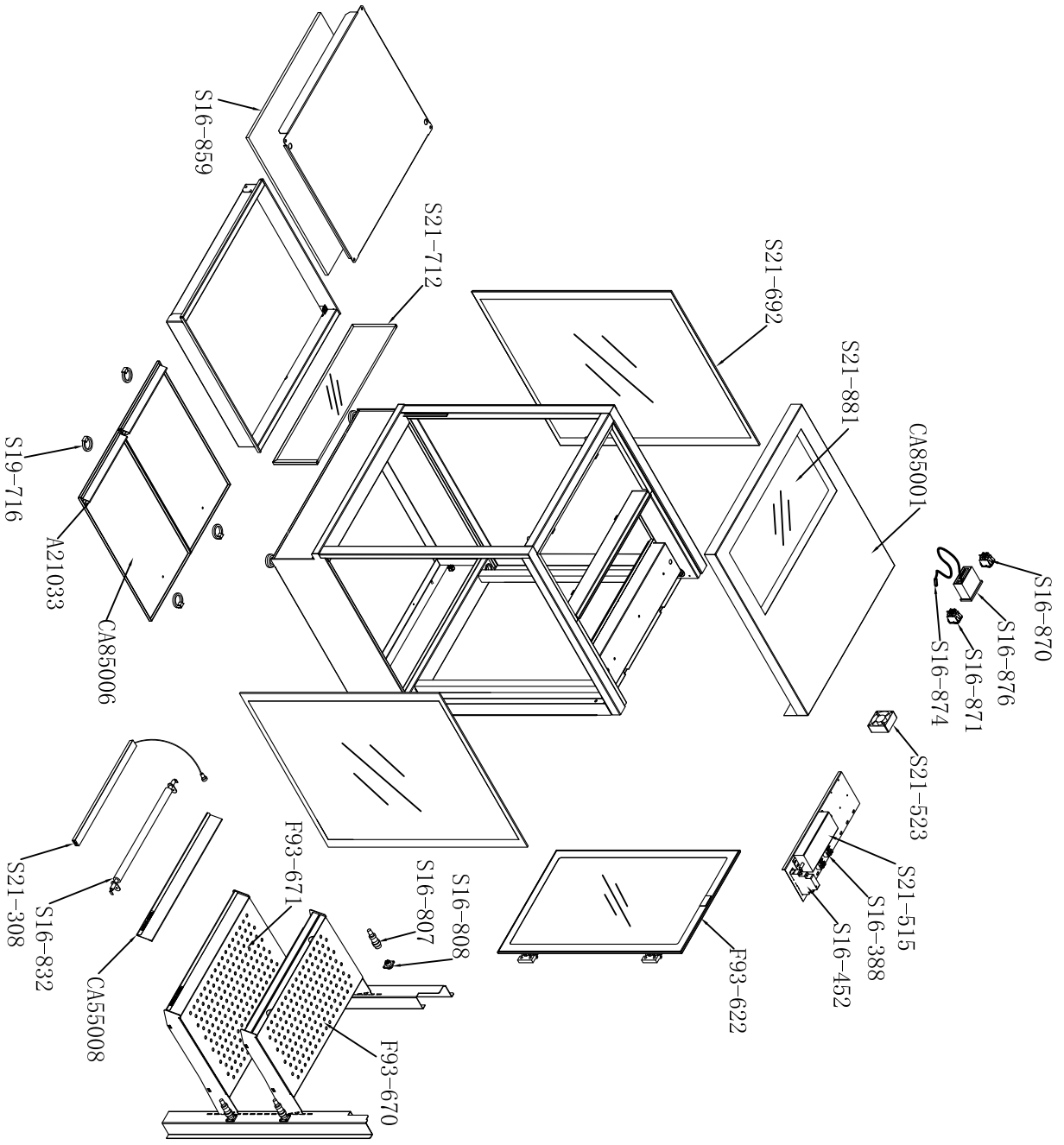

ID	Part No.	Name	Spec	QTY
1	A21033	Ticket strips of deck		2
2	CA55008	advertising board		2
3	CA85001	Top cover		1
4	CA85006	Deck trays		2
5	S16-388	Terminal block	250VAC, 2.5MM2	2
6	S16-452	Circuit breaker	NCH8-20/20 AC230V 50~60HZ	1
7	S16-807	Plug	WS16J3TQ-C, WE1PU, 3P	4
8	S16-808	Socket	WS16K3Z-C, WE1PU, 3P	4
9	S16-832	Heater	250W/230VAC	4
10	S16-859	Foil heater	250W/230V	1
11	S16-870	Power supply button	Dixel1 CXL5 green	1
12	S16-871	Lamp button	Dixel1 CXL5 yellow	1
13	S16-874	Sensor	Dixel1 NS6S 1.5M BN11080150	1
14	S16-876	Thermostat	Dixel1 XR02CX 240V/50HZ	1
15	S19-716	Pull ring		4
16	S21-308	LED light	L=400	4
17	S21-515	Water Proof Power Supply	LW100-0120833-BC00	1
18	S21-523	Flow fan	SUNON EF60251B2-000C-999	1
19	S21-692	Side glass		2
20	S21-712	Front glass		1
21	S21-881	Top glass		1
22	F93-622	Rear Door Assy		1
23	F93-670	Shelf (top)		1
24	F93-671	Shelf (middle)		1