

VER	DESCRIPTION OF REVISIONS	DATE
A-0		2017/09/28

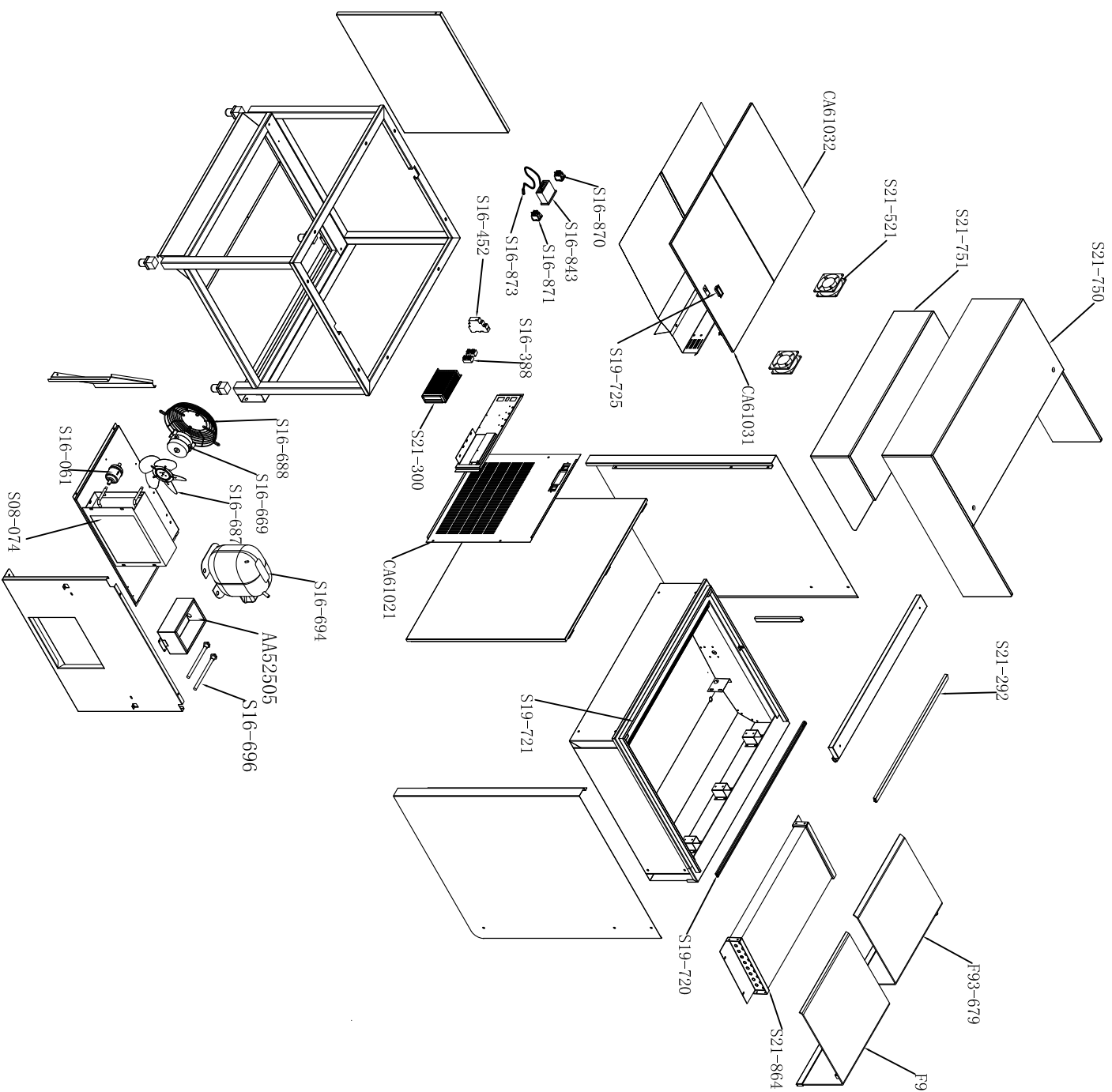

ID	Part No	Name	Spec	Unit	QTY	Note
1	AA52505	Evaporating pan with heater		PCS	1	
2	CA61021	Rear cover		PCS	1	
3	CA61031	Deck trays-left		PCS	1	
4	CA61032	Deck trays-right		PCS	1	
5	S08-074	Condenser	245	PCS	1	
6	S16-061	Filter	DML-053S-3/8"	PCS	1	
7	S16-388	Terminal block	250VAC, 2.5MM <sup>2</sup>	PCS	2	
8	S16-452	Circuit breaker	KCHB-20/20 AC230V 50/60Hz	PCS	1	
9	S16-669	Fan motor	SP-BHUEZ(9W)	PCS	1	
10	S16-687	Fan blade	FV800CH0538	PCS	1	
11	S16-688	Fan housing of motor	φ230-80	PCS	1	
12	S16-694	Compressor	SC18G	PCS	1	
13	S16-696	Heater	190W	PCS	2	
14	S16-843	Thermostat	Dixell XR06CX-5NOCT 240V/50Hz	PCS	1	
15	S16-870	Power supply button	Dixell CXLS green	PCS	1	
16	S16-871	Lamp button	Dixell CXLS yellow	PCS	1	
17	S16-873	Sensor	Dixell M66 3M	PCS	1	
18	S19-720	Door track		M	0.9	
19	S19-721	Hot aluminum bar		M	2.5	
20	S19-725	Handle		PCS	1	
21	S21-292	LED light	L=700	PCS	2	
22	S21-300	DC power supply	NES-50-12	PCS	1	
23	S21-521	Fan	SUNON SF25080A 220V 240V 50Hz	PCS	2	
24	S21-750	glass cover(outer)		PCS	1	
25	S21-751	glass cover(inside)		PCS	1	
26	S21-864	Evaporator		PCS	1	
27	F93-679	Rear PC Door Assy - Left		PCS	1	
28	F93-680	Rear PC Door Assy - Right		PCS	1	

Cosfiga F93-072 LPRF9