

VER	DESCRIPTION OF REVISIONS	DATE
A-0		2016/12/9

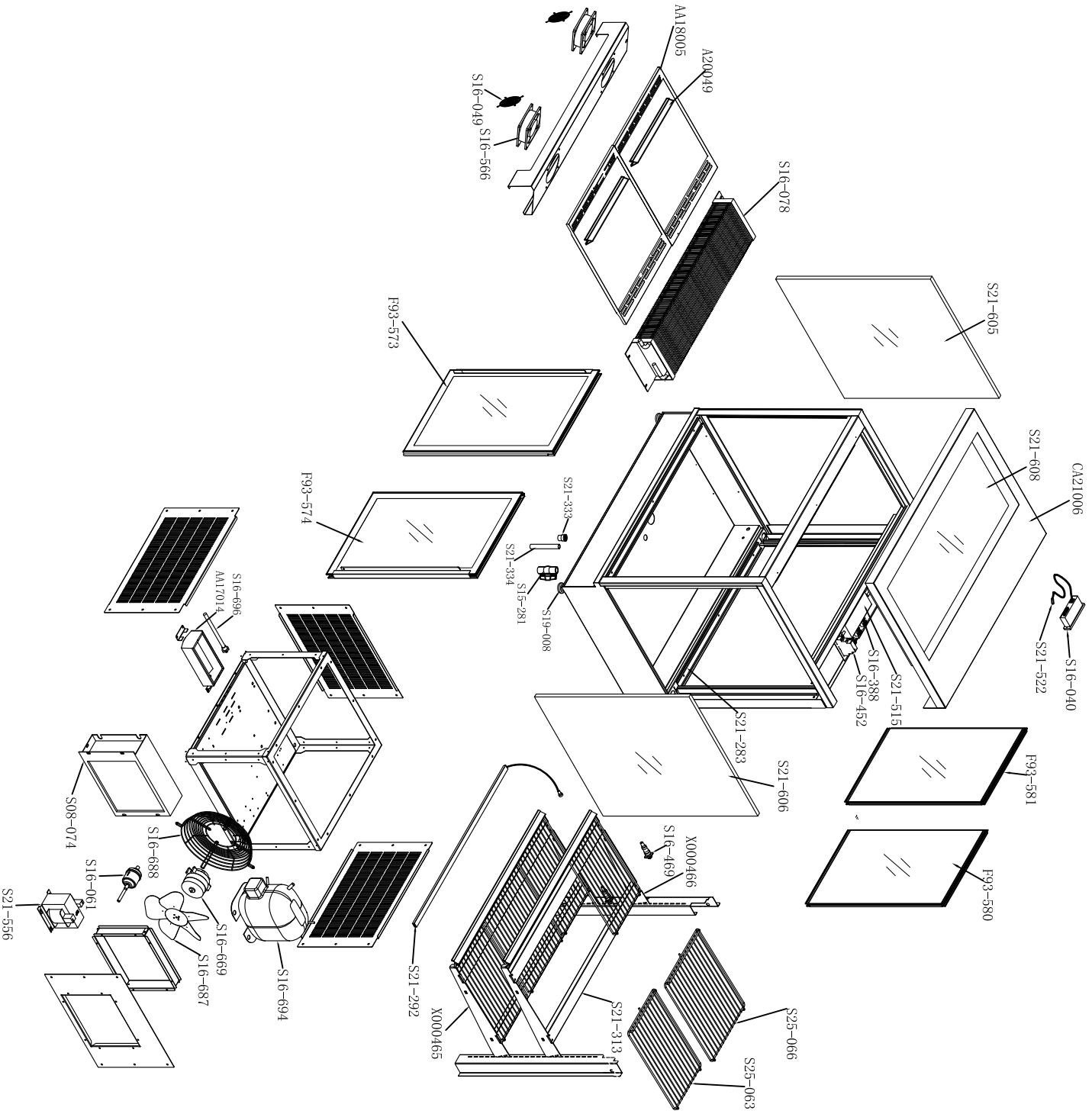

Cosiga P93-031 STGRF9

ID	Part No.	Name	Spec	Unit	Qty	Note
1	CA21006	Top cover		PCS	1	
2	A20049	Hooked strips of deek		PCS	2	
3	AA17014	Evaporating pan with heater		PCS	1	
4	AA18005	Deek trays		PCS	2	
5	F93-580	Rear Sliding Door - Left		PCS	1	
6	F93-581	Rear Sliding Door - Right		PCS	1	
7	F93-573	Front Sliding Door - Left		PCS	1	
8	F93-574	Front Sliding Door - Right		PCS	1	
9	S08-074	Condenser	245	PCS	1	
10	S16-281	Plastic ball-valve		PCS	1	
11	S16-040	Thermostat	PH000RHAI10 240V/30MVA	PCS	1	
12	S16-049	Fan board	120X120	PCS	2	
13	S16-051	Filter	ELIMINATOR/DML-063S-3/8"	PCS	1	
14	S16-078	Evaporator	90X195X776	PCS	1	
15	S16-388	Terminal Block	250VAC, 2.50MVA	PCS	3	
16	S16-452	Circuit Breaker	NCR8-20/20 AC220V 50 60MHZ	PCS	1	
17	S16-469	Connector-3PIN		SET	2	
18	S16-522	Sensor	NT025RH01-C48F	PCS	1	
19	S16-566	Fan	SHR63 RW1-SR109A1-22-1	PCS	2	
20	S16-659	Fan motor	SP-BHEHEE(9W)	PCS	1	
21	S16-657	Fan Blade	FV800C/303S8	PCS	1	
22	S16-688	Fan housing of motor	Φ240-80	PCS	1	
23	S16-694	Compressor	SC186- R134A	PCS	1	
24	S16-696	Heater	190W	PCS	1	
25	S19-008	Plastic footing	M10x55	PCS	4	
26	S21-292	LED Light	1=700	PCS	3	
27	S21-283	Door track		PCS	2	
28	S21-913	LED extension	1=787MM	PCS	4	
29	S21-333	Coupling pipe	20X1.2"	PCS	1	
30	S21-334	PCV pipe	DN20	PCS	0.1	
31	S21-515	DC power supply	LAT10-01208S3-9C00	PCS	1	
32	S21-556	Transformer	230V-38V	PCS	1	
33	S21-608	Top glass	820X399	PCS	1	
34	S21-605	Side glass		PCS	1	
35	S21-606	Side glass		PCS	1	
36	S25-063	Sheet	400X238	PCS	4	
37	S25-066	Sheet	400X300	PCS	2	
38	X000465	Crossbeam of shelf-right		PCS	1	
39	X000466	Crossbeam of shelf-left		PCS	1	