

Cossiga F93-030 STGRF6

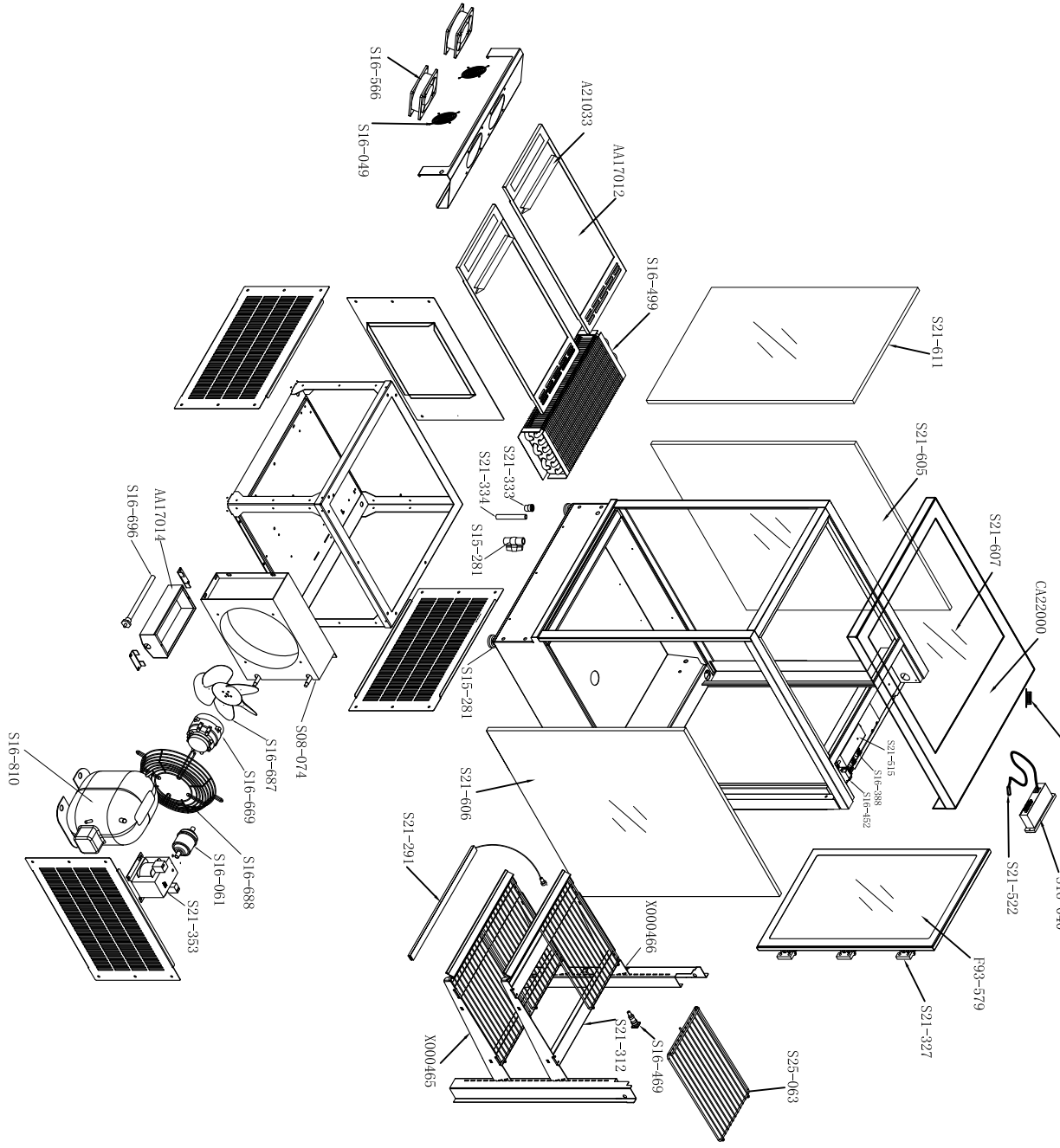

ID	Part No	Name	Spec	Unit	Qty	Note
1	CA22000	Top cover		PCS	1	
2	A21033	Ticken strips of deck		PCS	2	
3	AA17014	Evaporating pan with heater		PCS	1	
4	AA17012	Deck trays		PCS	2	
5	S08-074	Condenser	245	PCS	1	
6	S16-581	Plastic ball twelve		PCS	1	
7	S16-040	Thermostat	PROOFHAI10 240V/50HZ	PCS	1	
8	S16-049	Fan guard	120X120	PCS	2	
9	S16-061	Filter	ELIMINATOR/DML-06SS-9/8"	PCS	1	
10	S16-199	Evaporator	90X195X480	PCS	1	
11	S16-388	Terminal block	250VAC, 2.5MM2	PCS	3	
12	S16-452	Circuit breaker	NCHB-20/20 AC230V 50~60HZ	PCS	1	
13	S16-469	Connector, 3-PIN		SET	2	
14	S21-522	Sensor	NTC025H00-C40F	PCS	1	
15	S16-669	Fan	SIEHG KWEL-SK1094P-22-1	PCS	2	
16	S16-687	Fan motor	SI-69HLE2(9W)	PCS	1	
17	S16-687	Fan blade	FV800C30S38	PCS	1	
18	S16-688	Fan housing of motor	Φ230-80	PCS	1	
19	S16-696	Heater	190W	PCS	1	
20	S16-810	Compressor	SC15G R134A	PCS	1	
21	S19-004	Magnet		SET	1	
22	S19-008	Plastic footing	M10*55	PCS	4	
23	S21-291	LED light	L=400	PCS	3	
24	S21-312	LED extrusion	L=187MM	PCS	4	
25	S21-327	Hinge	50X50MM	PCS	3	
26	S21-333	Coupling pipe	20X1/2"	PCS	1	
27	S21-334	PVC pipe	DE30	PCS	0.1	
28	S21-353	Transformer	230V~381V, 250VA	PCS	1	
29	S21-515	DC power supply	LM100-0120833-RC00	PCS	1	
30	S21-605	Side glass		PCS	1	
31	S21-606	Side glass		PCS	1	
32	S21-607	Top glass	526X399	PCS	1	
33	S25-063	Shelf	400X238	PCS	4	
34	S21-611	Front glass		PCS	1	
35	X000465	Crossbeam of shelf-right		PCS	1	
36	X000466	Crossbeam of shelf-left		PCS	1	
37	F93-579	Rear Door Assy		PCS	1	