

VER	DESCRIPTION OF REVISIONS	DATE
A-0		2016/12/9

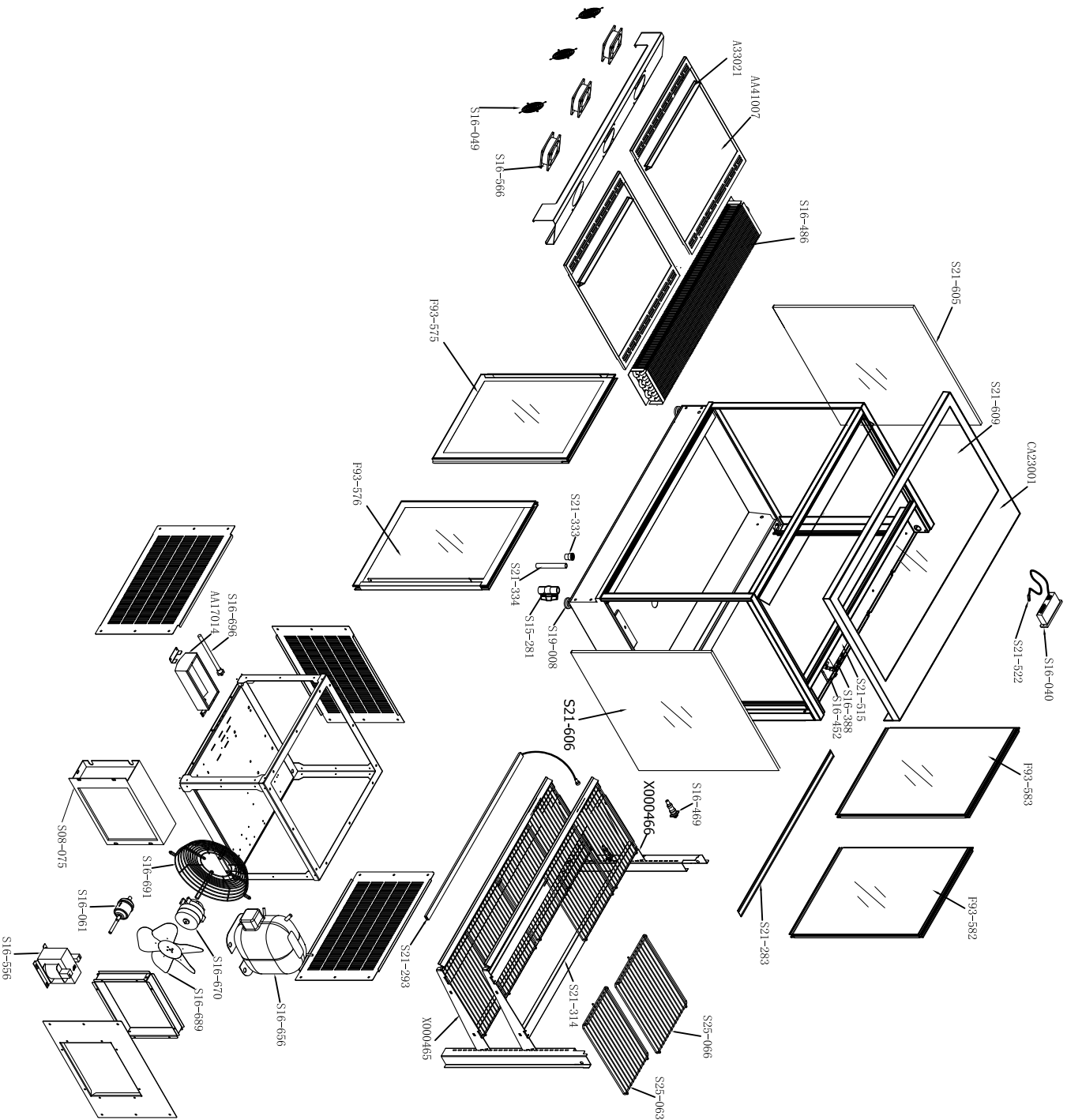

Cosiga F93-032 STGRF12

ID	Part No.	Name	Spec	Unit	Qty	Note
1	CA23001	Top cover		PCS	1	
2	A33021	Hook strips of deck		PCS	2	
3	AA17014	Evaporating pan with heater		PCS	1	
4	AA11007	Deck trays		PCS	2	
5	F93-582	Rear Sliding Door - Left		PCS	1	
6	F93-583	Rear Sliding Door - Right		PCS	1	
7	S08-075	Condenser	290	PCS	1	
8	S19-281	Plastic ball-valve		PCS	1	
9	S16-040	Thermostat	PH00010A10 240V/50HZ	PCS	1	
10	S16-049	Fan guard	120X120	PCS	3	
11	S16-061	Filter	ELIMINATOR DM-65S-3-8"	PCS	1	
12	S16-486	Evaporator	90X195X1080	PCS	1	
13	S16-388	Terminal block	250VAC, 2.5MM2	PCS	3	
14	S16-452	Circuit breaker	NC8B-20/20 AC220V 50/60HZ	PCS	1	
15	S16-489	Connector-3-pin		SPT	2	
16	S21-522	Sensor	NTC025HP0-C48F	PCS	1	
17	S16-566	Fan	SHFC RW1-SK109AP-22-1	PCS	3	
18	S16-636	Compressor	SC216 RI34A	PCS	1	
19	S16-670	Fan motor	SP-H16H1WZ16W	PCS	1	
20	S16-689	Fan blade	PV100CR30S38	PCS	1	
21	S16-691	Fan housing of motor	Φ270-80	PCS	1	
22	S16-696	Heater	190W	PCS	1	
23	S19-008	Plastic footline	M10x55	PCS	4	
24	S21-605	Slide glass		PCS	1	
25	S21-606	Slide glass		PCS	1	
26	S21-293	LED light	L=1000	PCS	3	
27	S21-515	DC power supply	LA100-0208S3-R000	PCS	1	
28	S21-314	LED extrusion	L=1087MM	PCS	4	
29	S21-333	Coupling pipe	20X11.2"	PCS	1	
30	S21-334	PVC pipe	0/20	PCS	0.1	
31	S21-556	Transistor	220V-36V	PCS	1	
32	S21-609	Top glass	1125X399	PCS	1	
33	S25-063	Shell	400X228	PCS	4	
34	S25-066	Shell	400X300	PCS	4	
35	X000465	Crossbeam of shell-left		PCS	1	
36	X000466	Crossbeam of shell-right		PCS	1	
37	F93-575	Front Sliding Door - Left		PCS	1	
38	F93-576	Front Sliding Door - Right		PCS	1	
39	S21-283	Door track		PCS	2	