

VER	DESCRIPTION OF REVISIONS	DATE
A-0		2017/08/01

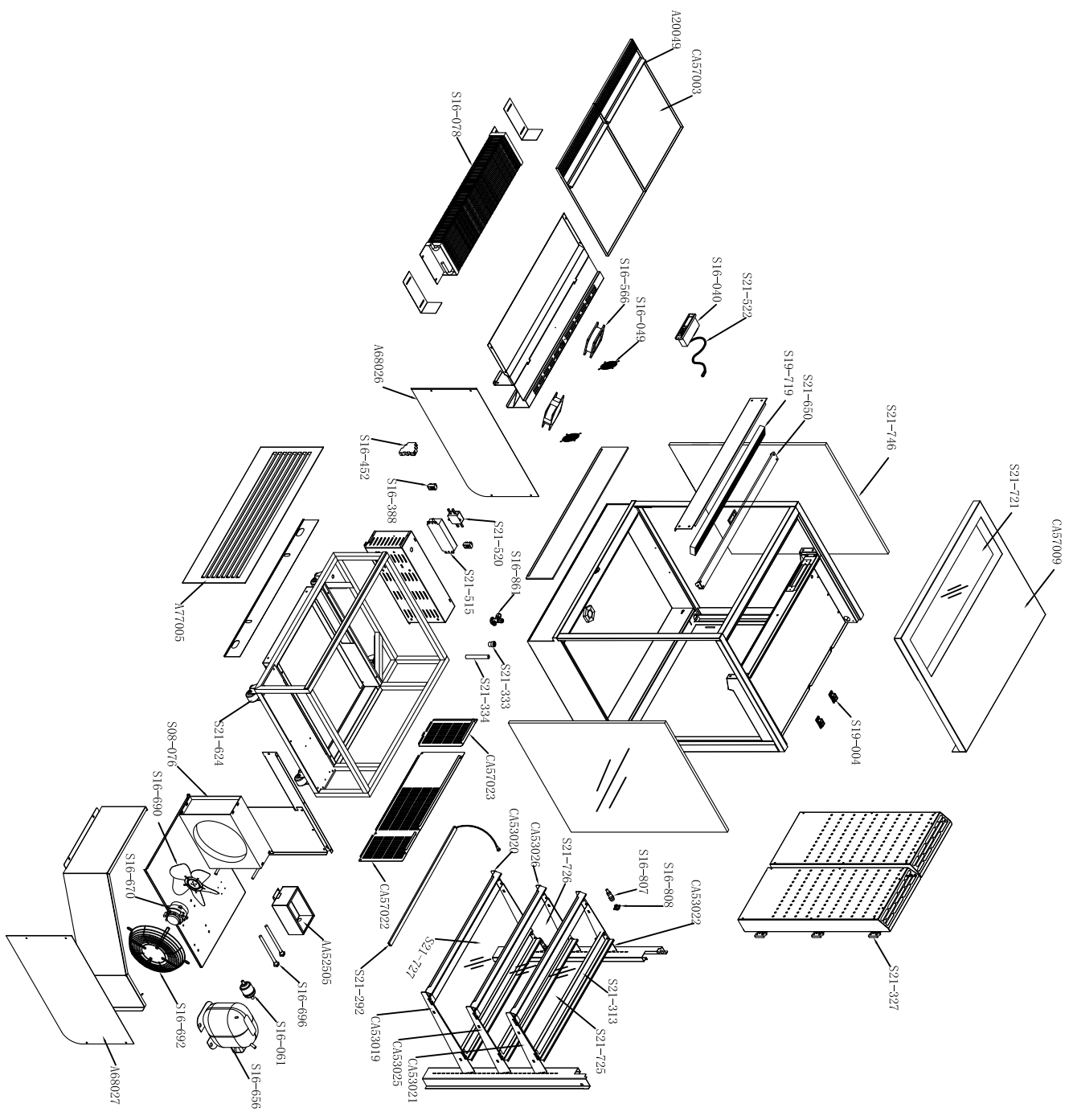

ID	Part No.	Name	Spec.	Unit	Qty	Note
1	A20049	Ticket strips of deck		PCS	2	
2	A68026	Left side cover		PCS	1	
3	A68027	Right side cover		PCS	1	
4	A77005	Front Shutter		PCS	1	
5	MA52505	Evaporating pan with heater		PCS	1	
6	CA57009	Top cover		PCS	1	
7	CA57003	Deck trays		PCS	2	
8	CA57022	Rear cover		PCS	1	
9	CA57023	Front cover-Left		PCS	1	
10	S08-076	Condenser	330	PCS	1	
11	S16-040	Thermostat	PH00001A10 240V/50HZ	PCS	1	
12	S16-049	Fan guard	120X120	PCS	2	
13	S16-061	Filter	DM-0535-3/8"	PCS	1	
14	S16-078	Evaporator	0.D. 90X195X776	PCS	1	
15	S16-388	Terminal block	250VAC 2.5MM2	PCS	3	
16	S16-452	Circuit breaker	NC18-20/20 AC230V 50°60HZ	PCS	1	
17	S21-522	Sensor	NTC026H00	PCS	1	
18	S16-566	Fan	SHENG KME1-S8109AP-22-1	PCS	2	
19	S16-656	Compressor	SECOP- SC216 R134A	PCS	1	
20	S16-670	Fan motor	SP-B16HDM2 (16W)	PCS	1	
21	S16-690	Fan blade	PV120C030S63	PCS	1	
22	S16-692	Fan housing of motor	Φ-330-80	PCS	1	
23	S16-696	Heater	190W	PCS	2	
24	S16-807	Plug	WS16J910-C, WE1PL_3P	PCS	3	
25	S16-808	Socket	MS16K37-C, WE1PL_3P	PCS	3	
26	S16-861	Expansion valve	TV2 068Z334F	PCS	1	
27	S19-004	Magnet		SET	2	
28	S19-719	Homeycomb Wind deflector		PCS	1	
29	S21-292	LED light	L=700	PCS	5	
30	S21-313	LED extrusion	L=787MM	PCS	6	
31	S21-327	Hinge	50X50MM	PCS	6	
32	S21-333	Comping pipe	20X1.2"	PCS	1	
33	S21-334	PVC pipe	DN20	PCS	0.05	
34	S21-515	DC power supply	LM100-0120833-8000	PCS	1	
35	S21-520	RMI Filter	H1170-10-18-43	PCS	1	
36	S21-624	Adjustable Castor	2"	PCS	4	
37	S21-650	Night blind		PCS	1	
38	S21-746	Side glass		PCS	2	
39	S21-721	Top glass		PCS	1	
40	S21-725	Glass of shelf (top)		PCS	1	
41	S21-726	Glass of shelf (middle)		PCS	1	
42	S21-727	Glass of shelf (bottom)		PCS	1	
43	CA53021	Grossbeam of shelf-right		PCS	1	
44	CA53022	Grossbeam of shelf-left		PCS	1	
45	CA53025	Grossbeam of shelf-right		PCS	1	
46	CA53026	Grossbeam of shelf-left		PCS	1	
47	CA53019	Grossbeam of shelf-right		PCS	1	
48	CA53020	Grossbeam of shelf-left		PCS	1	

Cassiga F93-068 TTGOR9