

VER	DESCRIPTION OF REVISIONS	DATE
A-0		2017/03/27
A-1	Change to TX valve (S16-861)	2017/07/10

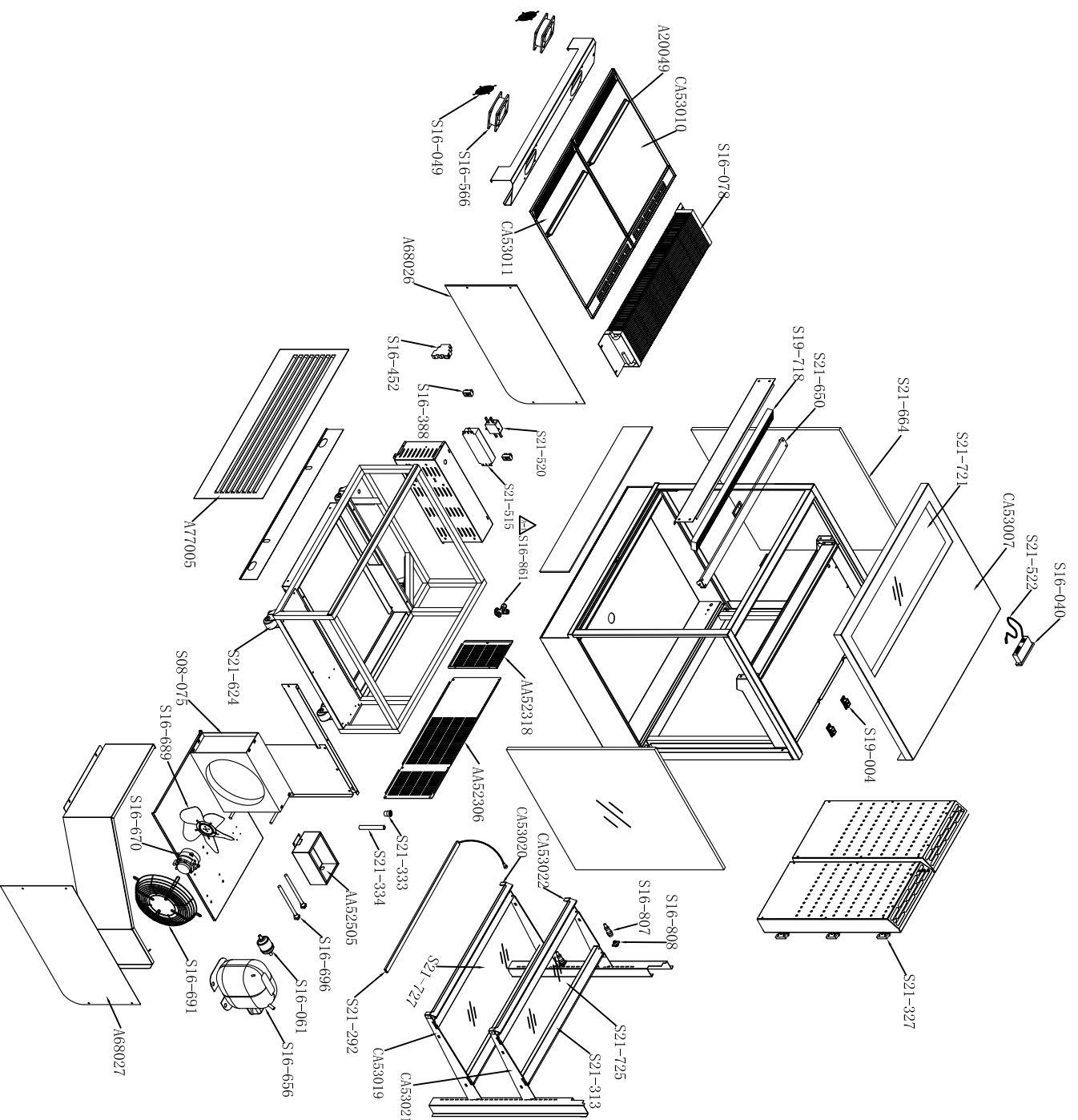

ID	Part No.	Name	Spec	Unit	Qty	Note
1	A20049	Token strips of deck		PCS	2	
2	A68026	Left side cover		PCS	1	
3	A68027	Right side cover		PCS	1	
4	A77005	Front blower		PCS	1	
5	AA52306	Rear cover		PCS	1	
6	AA52318	Rear cover-left		PCS	1	
7	AA52505	Evaporating pan with heater		PCS	1	
8	CA53007	Top cover		PCS	1	
9	CA53010	Deck trays-left		PCS	1	
10	CA53011	Deck trays-right		PCS	1	
11	S08-075	Condenser	290	PCS	1	
12	S16-040	Thermostat	PH000P0A10 240V/50HZ	PCS	1	
13	S16-049	Fan guard	120V120	PCS	2	
14	S16-061	Filter	DU-0583-3/8"	PCS	1	
15	S16-388	Terminal block	250V/AC, 2.5MM2	PCS	3	
16	S16-452	Circuit breaker	NCR8-20/20 AC230V 50°60HZ	PCS	1	
17	S16-078	Evaporator	0.0.300196XV76	PCS	1	
18	S21-522	Sensor	NT0255HP00	PCS	1	
19	S16-506	Fan	SIMNC KEM-SKT09M-22-1	PCS	2	
20	S16-670	Fan motor	SP-416HBM2(10W)	PCS	1	
21	S16-556	Compressor	SEBOP- SC21G R134A	PCS	1	
22	S16-689	Fan blade	PT100CTR03650	PCS	1	
23	S16-691	Fan housing of motor	φ280-80	PCS	1	
24	S16-696	Heater	190W	PCS	2	
25	S16-807	Plug	MS161317G-C, WE1PL 3P	PCS	2	
26	S16-808	Socket	MS16K32-C, WE1PL 3P	PCS	3	
27	S16-861	Expansion valve	TN2 06828347	SET	1	
28	S19-004	Magnet		SET	2	
29	S19-718	Homocomb Wind deflector		PCS	1	
30	S21-292	LED Light	L=700	PCS	4	
31	S21-313	LED extension	L=787MM	PCS	4	
32	S21-327	Hinge	50X50MM	PCS	6	
33	S21-333	Coupling pipe	20X1/2"	PCS	1	
34	S21-334	PVC pipe	DE20	PCS	0.05	
35	S21-515	DC power supply	DM100-0120833-4000	PCS	1	
36	S21-520	EMI Filter	HT170-10-48-83	PCS	1	
37	S21-624	Adjustable Castor	2"	PCS	4	
38	S21-650	Wight blind		PCS	1	
39	S21-664	Side glass		PCS	2	
40	S21-721	Top glass		PCS	1	
41	S21-725	Glass of shelf (top)		PCS	1	
42	S21-727	Glass of shelf (bottom)		PCS	1	
43	CA53021	Crossbeam of shelf-right		PCS	1	
44	CA53019	Crossbeam of shelf-left		PCS	1	
45	CA53019	Crossbeam of shelf-right		PCS	1	
46	CA53020	Crossbeam of shelf-left		PCS	1	

Cassiga F93-055 BTGR9