

| VER | DESCRIPTION OF REVISIONS | DATE |
|-----|--------------------------|------------|
| A-0 | | 2014/07/12 |

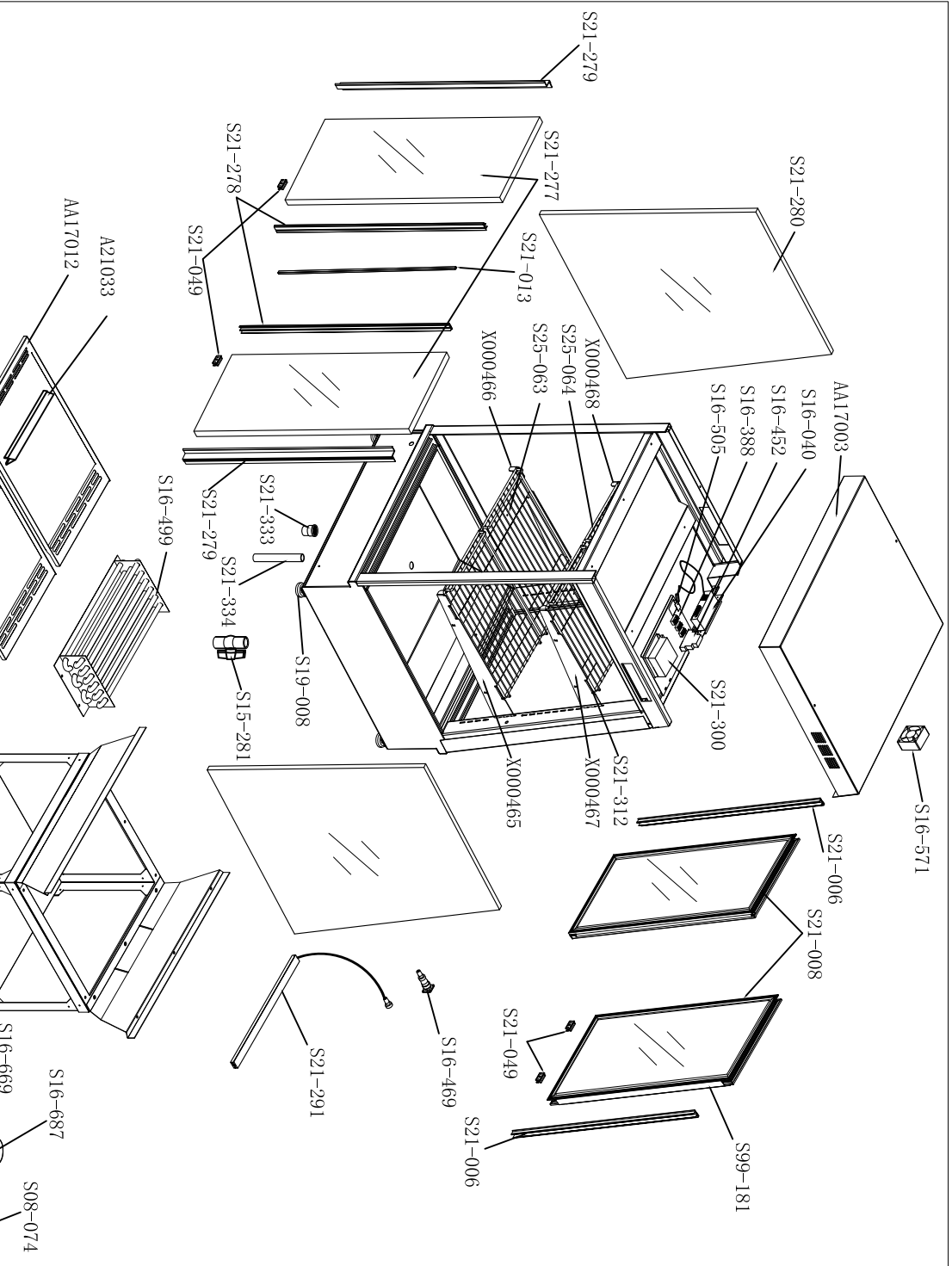

| ID | Part No | Name | Spec | Unit | Qty | Note |
|----|---------|--|---------------------------|------|-----|------|
| 1 | A21033 | Tricker strips of deck | | PCS | 2 | |
| 2 | AA17003 | Top cover | | PCS | 1 | |
| 3 | AA17012 | Deck covers | | PCS | 2 | |
| 4 | AA17014 | Propagating pan with heater | | PCS | 1 | |
| 5 | S21-277 | Glass panel, front | | SPT | 2 | |
| 6 | S21-007 | Glass frame | | PCS | 2 | |
| 7 | F92-216 | S21-019 roller (Left) | | PCS | 8 | |
| 8 | F92-217 | S21-219 door handle, front glass (Right) | | PCS | 2 | |
| 9 | F92-217 | S21-013 Rubber seal (Right) | | PCS | 2 | |
| 10 | S21-015 | PVC stopper | | PCS | 6 | |
| 11 | S21-278 | Protector strip | | PCS | 2 | |
| 12 | X000541 | Alum seal | | PCS | 2 | |
| 13 | S21-007 | Glass frame | | PCS | 2 | |
| 14 | F90-884 | S21-008 Glass panel, rear (Left) | | SPT | 2 | |
| 15 | F90-885 | S21-019 roller | | PCS | 8 | |
| 16 | S99-181 | Door handle, rear glass (Right) | | PCS | 2 | |
| 17 | S21-013 | Rubber seal | | PCS | 2 | |
| 18 | S21-001 | Label | | PCS | 2 | |
| 19 | S08-074 | Condenser | | PCS | 1 | |
| 20 | S15-281 | plastic ball-valve | | PCS | 1 | |
| 21 | S16-010 | Thermostat | PROODHDA10 240V/50HZ | PCS | 1 | |
| 22 | S16-019 | Fan board | L201120 | PCS | 2 | |
| 23 | S16-061 | Flitter | DL1M1M10K 30M-4535-3/8" | PCS | 1 | |
| 24 | S16-388 | Terminal block | 250VAC, 2.5002 | PCS | 3 | |
| 25 | S16-452 | Circuit breaker | NCH8-50/20 AC230V 50-60HZ | PCS | 1 | |
| 26 | S16-469 | Connector, 3-4IN | | SPT | 2 | |
| 27 | S16-499 | Evaporator | 90V193X180 | PCS | 1 | |
| 28 | S16-505 | Sensor | NT015H00C-CHR | PCS | 1 | |
| 29 | S16-566 | Fan | SHENG_RMT-S8100A1-22-1 | PCS | 2 | |
| 30 | S16-571 | Katid Flow fan | M42062-PL | PCS | 1 | |
| 31 | S16-689 | Fan motor | SF-99H1M2(90) | PCS | 1 | |
| 32 | S16-687 | Fan blade | FV800K30538 | PCS | 1 | |
| 33 | S16-688 | Fan housing of motor | q-230-50 | PCS | 1 | |
| 34 | S16-694 | Compressor | SC186 | PCS | 1 | |
| 35 | S16-696 | Heater | 110x55 | PCS | 1 | |
| 36 | S19-008 | Plastic Footing | | PCS | 4 | |
| 37 | S21-280 | Side glass | | PCS | 2 | |
| 38 | S21-291 | LED light | L=1100 | PCS | 3 | |
| 39 | S21-300 | DC power supply | MS-50-12 | PCS | 1 | |
| 40 | S21-312 | LED extrusion | L=1870M | PCS | 5 | |
| 41 | S21-333 | Coilnging pipe | 20X1/2" | PCS | 1 | |
| 42 | S21-334 | PVC pipe | DN20 | PCS | 0.1 | |
| 43 | S25-063 | Shaft | 400X238 | PCS | 2 | |
| 44 | S25-064 | Shaft | 360X238 | PCS | 2 | |
| 45 | X000465 | Crossbeam of shell-right | | PCS | 1 | |
| 46 | X000466 | Crossbeam of shell-left | | PCS | 1 | |
| 47 | X000467 | Crossbeam of shell-right | | PCS | 1 | |
| 48 | X000468 | Crossbeam of shell-left | | PCS | 1 | |