

VER	DESCRIPTION OF REVISIONS	DATE
A-0		2014/04/26

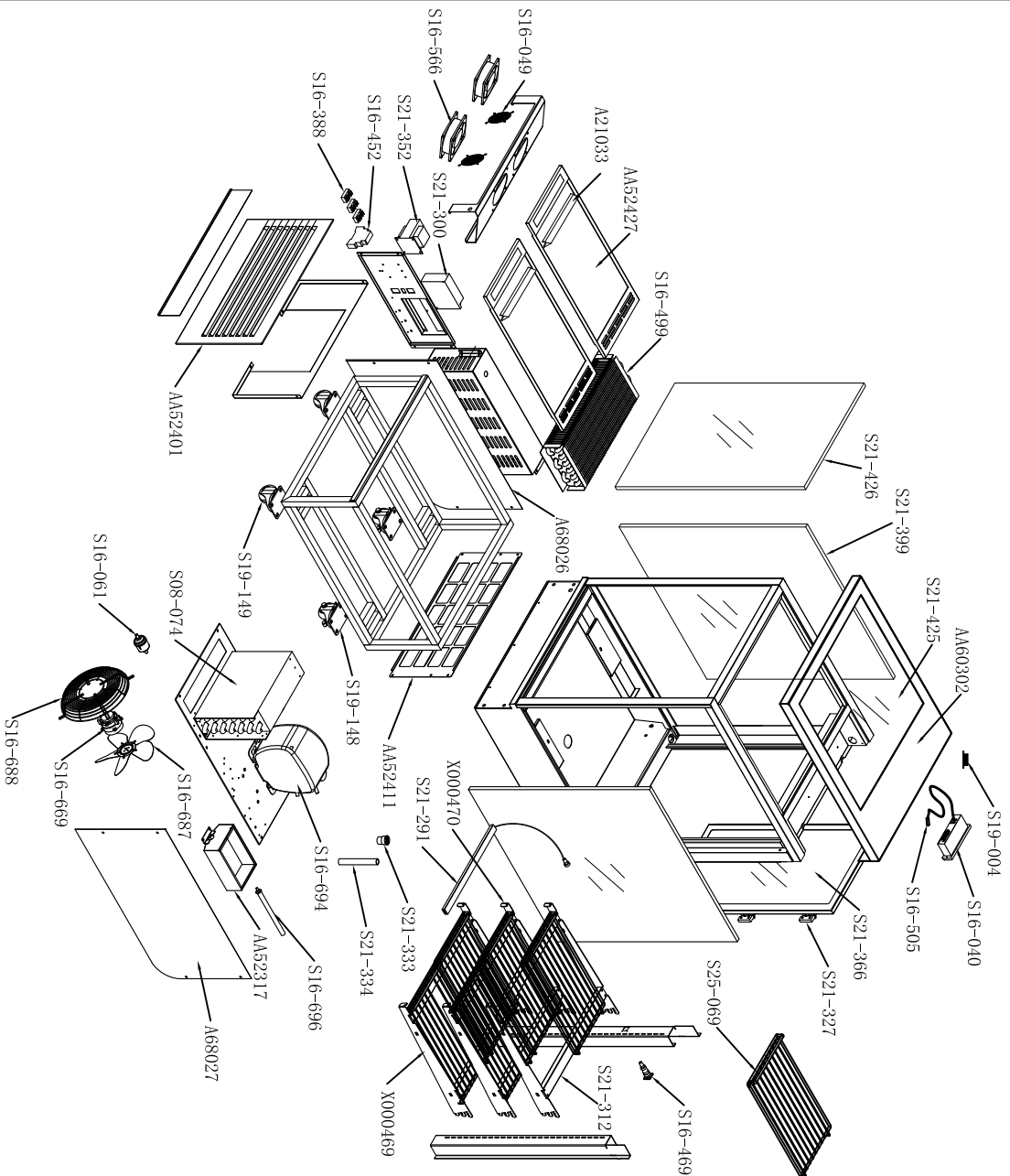

Cossiga P92-707 BICRPF6

ID	Part No	Name	Spec	Unit	QTY	Note
1	A21033	Ticket strips of deck		PCS	2	
2	A68026	Left side cover		PCS	1	
3	A68027	Right side cover		PCS	1	
4	AA52317	Evaporating pan with heater		PCS	1	
5	AA52401	Front Shutter		PCS	1	
6	AA52411	Rear cover		PCS	1	
7	AA52427	Deck trays		PCS	2	
8	AA60302	Top cover	245	PCS	1	
9	S08-074	Condenser	PH007F0A10 240V/50HZ	PCS	1	
10	S16-040	Thermostat	120X120	PCS	2	
11	S16-049	Fan guard	DML-653S-3/8"	PCS	1	
12	S16-061	Filter	250VAC, 2.5MM2	PCS	3	
13	S16-388	Terminal block	NGH8-20/20 AC230V 50°60HZ	PCS	1	
14	S16-452	Circuit breaker		SFT	3	
15	S16-469	Connector, 3-PTN		PCS	1	
16	S16-499	Evaporator	0.D. 90X195X480 (12.7MM)	PCS	1	
17	S16-505	Sensor	NTC015HP00-CRF	PCS	1	
18	S16-566	Fan	SHENG KWFL-SR109AP-22-1	PCS	2	
19	S16-669	Fan motor	SP-B9HHEM2 (9W)	PCS	1	
20	S16-687	Fan blade	FV800C/R30S38	PCS	1	
21	S16-688	Fan housing of motor	Φ230-80	PCS	1	
22	S16-694	Compressor	SC18G	PCS	1	
23	S16-696	Heater	190W	PCS	1	
24	S19-004	Magnet		SFT	1	
25	S19-148	Castor C/W Break	2.5"	PCS	2	
26	S19-149	Castor	2.5"	PCS	2	
27	S21-291	LED light	1=400	PCS	4	
28	S21-300	DC power supply	NES-50-12	PCS	1	
29	S21-312	LED extrusion	1=487MM	PCS	7	
30	S21-327	Hinge	50X50MM	PCS	3	
31	S21-333	Coupling pipe	20X1/2"	PCS	1	
32	S21-334	PVC pipe	DE20	PCS	0.05	
33	S21-352	Transformer	230V-36V, 200VA	PCS	1	
34	S21-366	Rear glass		PCS	1	
35	S21-399	Side glass		PCS	2	
36	S21-425	Top glass		PCS	1	
37	S21-426	Front glass		PCS	1	
38	S25-069	shelf	445X238	PCS	6	
39	X000469	crossbeam of shelf=right		PCS	3	
40	X000470	crossbeam of shelf=left		PCS	3	