

VER	DESCRIPTION OF REVISIONS	DATE
A-0		2017/09/05

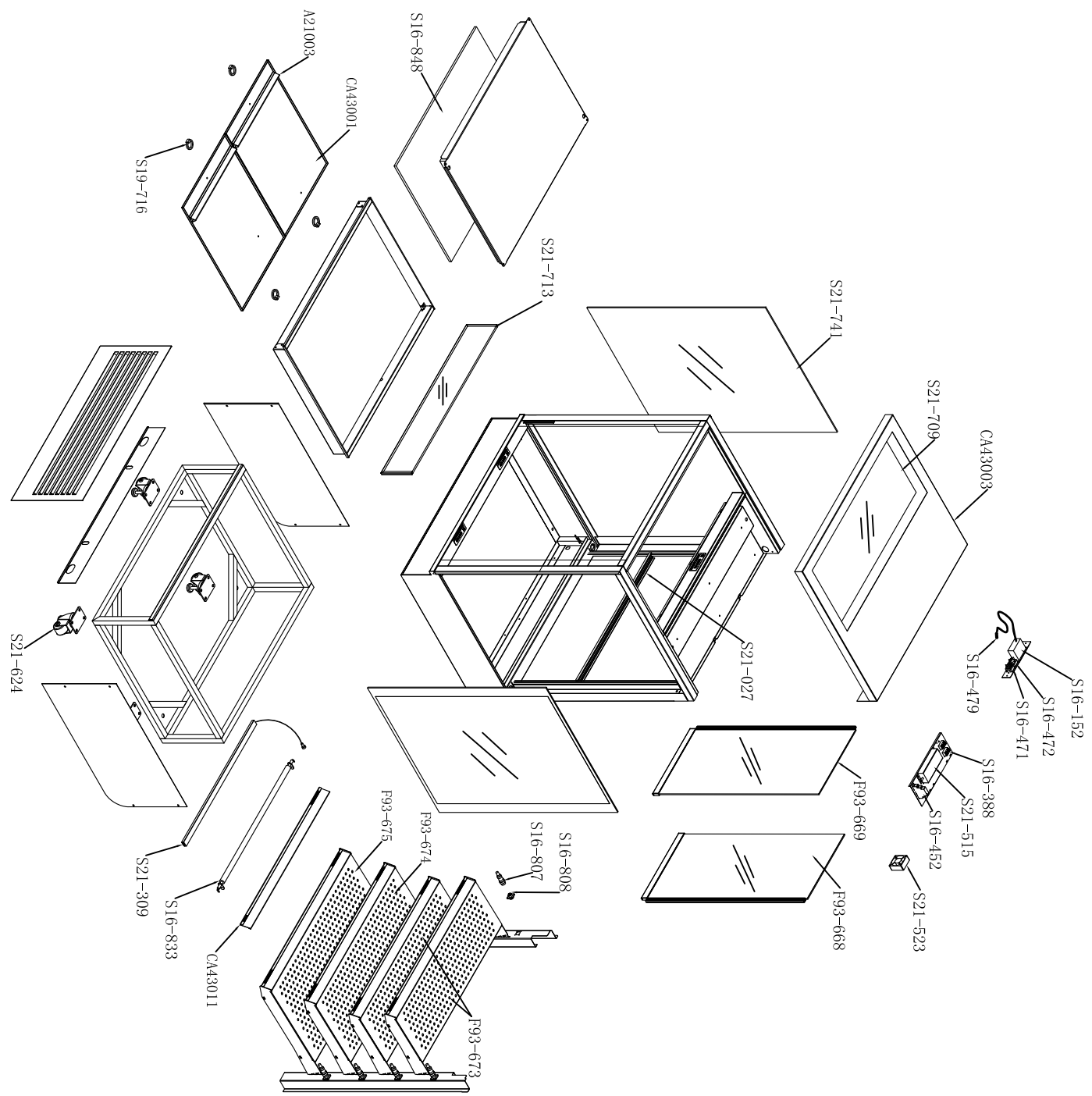

**F93-071 TTGOH9 Part List**

ID	Part No.	Name	Spec	QTY
1	A20049	Ticket strips of deck		2
2	CA43001	Deck trays		2
3	CA43003	Top cover		1
4	CA43011	advertising board		3
5	S16-152	Thermostat	CAREL IR33S0ER00 240V/50HZ 250VAC, 2.5MM2	1
6	S16-388	Terminal block	NCH8-20/20 AC230V 50~60HZ	2
7	S16-452	Circuit breaker	PEOPZSRG10 green	1
8	S16-471	Power supply button	PEOPZSRML0 white	1
9	S16-472	Lamp button	NTC015WRP00-CAHT	1
10	S16-479	Sensor	WS16J3TQ-C, WE1PLU, 3P	6
11	S16-807	Plug	WS16K3Z-C, WE1PLU, 3P	6
12	S16-808	Socket	400W/230VAC	6
13	S16-833	Heater	400W/230VAC	1
14	S16-848	Foil heater	400W/230V	1
15	S19-716	Pull ring		4
16	S21-027	Door track		1
17	S21-309	LED light	L=700	5
18	S21-741	Side glass		2
19	S21-515	Water Proof Power Supply	LW100-0120833-BC00	1
20	S21-523	flow fan	SINON EH60251B2-000C-999	1
21	S21-624	Adjustable Castor	2"	4
22	S21-709	Top glass		1
23	S21-713	Front glass		1
24	S21-668	Left Rear Door Assy		1
25	S21-669	Right Rear Door Assy		1
26	S21-673	Shelf (top)		1
27	S21-674	Shelf (middle)		1
28	S21-675	Shelf (bottom)		1