

VER	DESCRIPTION OF REVISIONS	DATE
A-0		2017/07/06
A-1	Castor change to S16-864	2017/08/03

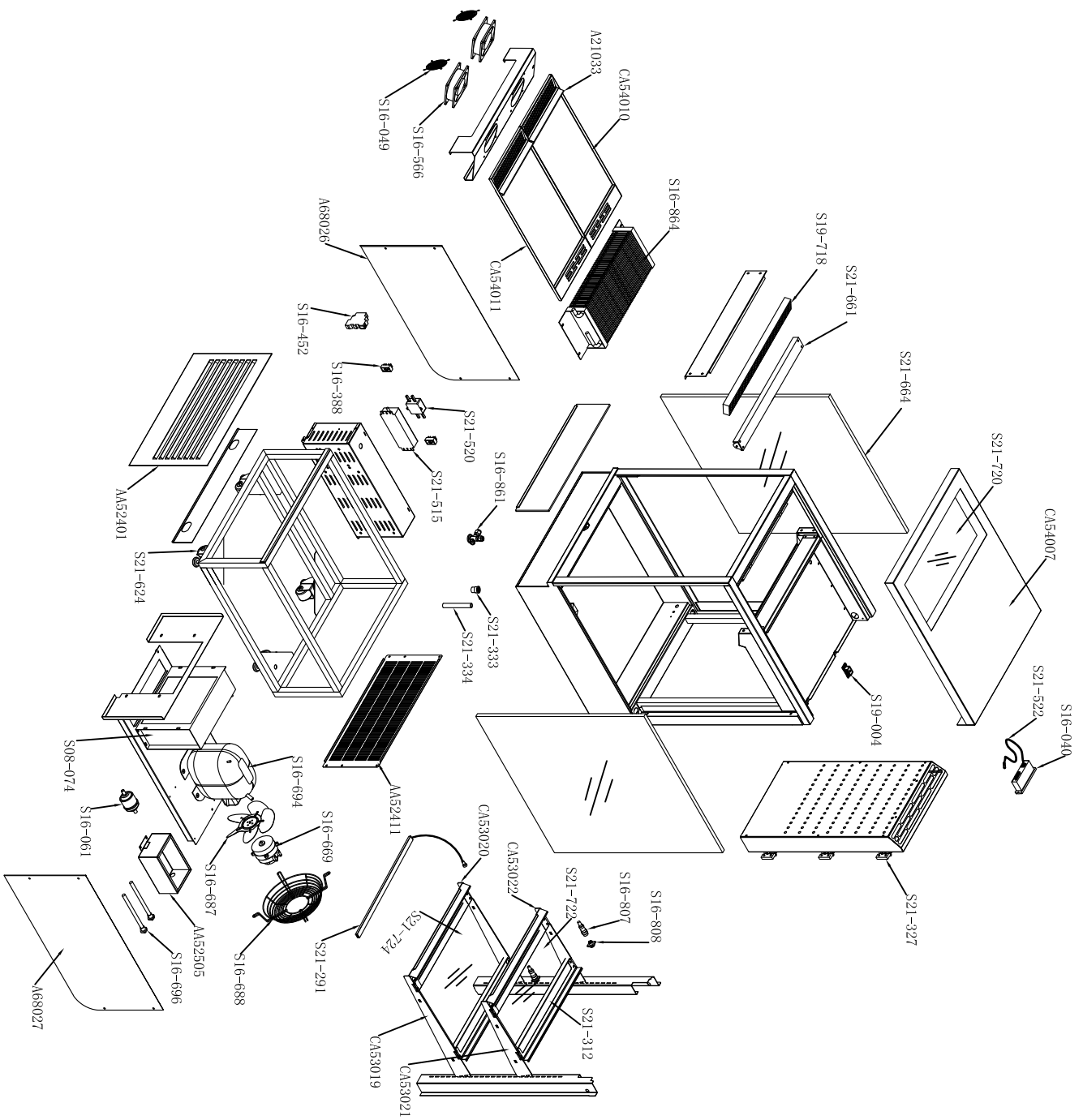

ID	Part No.	Name	Spec	Unit	Qty	Note
1	A21033	Ticket strips of deck		PCS	2	
2	A68026	Left side cover		PCS	1	
3	A68027	Right side cover		PCS	1	
4	AAS2401	Front Shutter		PCS	1	
5	AAS2411	Rear cover		PCS	1	
6	AAS2505	Evaporating pan with heater		PCS	1	
7	CAS4010	Top cover		PCS	1	
8	CAS4010	Deck trays=left		PCS	1	
9	CAS4011	Deck trays=right		PCS	1	
10	S08-074	Condenser	216	PCS	1	
11	S16-040	Thermostat	PH000R1A10 240V/50HZ	PCS	1	
12	S16-049	Fan guard	120X120	PCS	2	
13	S16-061	Filter	DM1-055S-3/8"	PCS	1	
14	S16-388	Terminal block	250VAC, 2.5MM2	PCS	3	
15	S16-452	Circuit breaker	NBBR-20/20 AC220V 50 60HZ	PCS	1	
16	S16-566	Fan	SIN6G RWEL-SK09AP-22-1	PCS	2	
17	S16-687	Fan blade	FR800CR30S38	PCS	1	
18	S16-688	Fan housing of motor	Φ230-80	PCS	1	
19	S16-694	Compressor	SEPC0P- SC18G R134A	PCS	1	
20	S16-696	Heater	190W	PCS	2	
21	S16-669	Fan motor	S=80H(DM2) (9W)	PCS	1	
22	S16-807	Plug	MS161310-C, WE1PL, 3P	PCS	2	
23	S16-808	Socket	MS16K3Z-C, WE1PL, 3P	PCS	3	
24	S16-861	Expansion valve	TV2 068Z3347	SET	1	
25	S16-864	Evaporator	0.1. 30X260X180	PCS	1	
26	S19-004	Magnet		SET	1	
27	S19-718	Honeycomb Wind deflector		PCS	1	
28	S21-291	LED Light	L=400	PCS	4	
29	S21-312	LED extrusion	L=4870MM	PCS	4	
30	S21-327	Hinge	50X50MM	PCS	3	
31	S21-333	Coupling pipe	20X17,2"	PCS	1	
32	S21-334	PVC pipe	DE20	PCS	0.1	
33	S21-515	DC power supply	LM100-0120833-BCC00	PCS	1	
34	S21-520	DMT Filter	HT170-10-18-B3	PCS	1	
35	S21-522	Sensor	NTR025HP00	PCS	1	
36	S21-624	Adjustable Castor	2"	PCS	4	
37	S21-661	Night blind	550	PCS	1	
38	S21-664	Side glass		PCS	2	
39	S21-720	Top glass		PCS	1	
40	S21-722	Glass of shelf (top)		PCS	1	
41	S21-724	Glass of shelf (bottom)		PCS	1	
42	CAS3021	Crossbeam of shelf=right		PCS	1	
43	CAS3022	Crossbeam of shelf=left		PCS	1	
44	CAS3019	Crossbeam of shelf=right		PCS	1	
45	CAS3020	Crossbeam of shelf=left		PCS	1	