

VER	DESCRIPTION OF REVISIONS	DATE
A-0		2016/02/07
A-1	Change to TX valve (S16-861)	2017/07/10

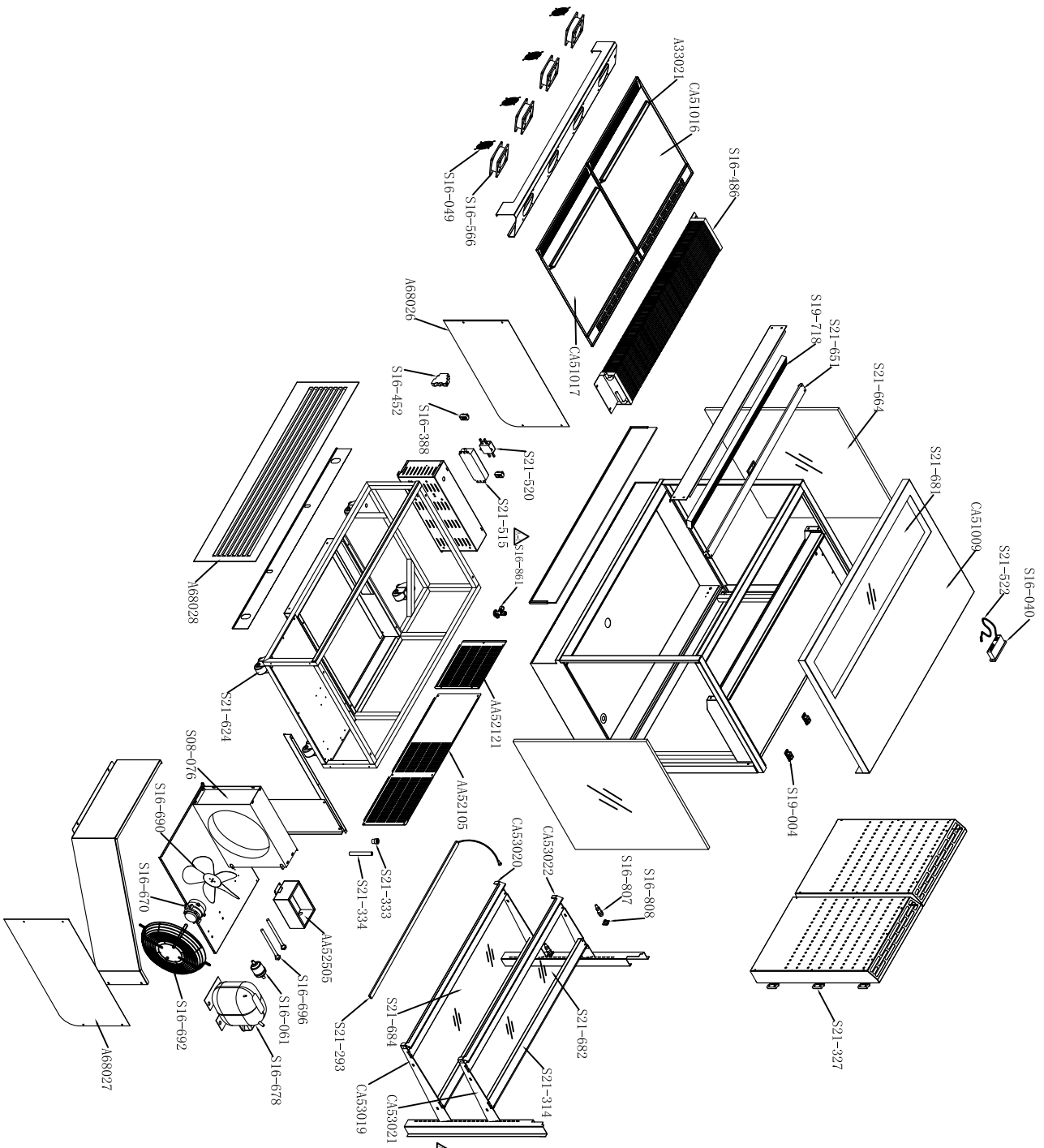

ID	Part No.	Name	Spec	Unit	Qty	Note
1	A33021	Ticket strips of deck		PCS	2	
2	A68026	Left slide cover		PCS	1	
3	A68027	Right slide cover		PCS	1	
4	A68028	Front Shutter		PCS	1	
5	MA52105	Rear cover		PCS	1	
6	MA52121	Rear cover-left		PCS	1	
7	MA52505	Evaporating pan with heater		PCS	1	
8	CA51009	Top cover		PCS	1	
9	CA51016	Back trays-left		PCS	1	
10	CA51017	Back trays-right		PCS	1	
11	S08-076	Condenser	330	PCS	1	
12	S16-040	Thermostat	PH00PH410 240V/50HZ	PCS	1	
13	S16-049	Fan guard	L20X120	PCS	4	
14	S16-061	Filter	DM-03S-3/8"	PCS	1	
15	S16-388	Terminal block	250VAC, 2.5MM2	PCS	3	
16	S16-452	Circuit breaker	MBP-50/20 AC230V 50 60HZ	PCS	1	
17	S16-486	Evaporator	0.D.90X195X1080 (12.700)	PCS	1	
18	S21-522	Sensor	NTC025HP00	PCS	1	
19	S16-566	Fan	SIENG. KME-SK109MF-22-1	PCS	4	
20	S16-670	Fan motor	SP-H16H10M2(16V)	PCS	1	
21	S16-678	Compressor	SC00-G326MX R134A	PCS	1	
22	S16-690	Fan blade	FV120C090S63	PCS	1	
23	S16-692	Fan housing of motor	42320-80	PCS	1	
24	S16-696	Heater	190W	PCS	2	
25	S16-807	Plug	WS161310-C, WE1PL, 3P	PCS	2	
26	S16-808	Socket	WS16R5Z-C, WE1PL, 3P	PCS	3	
27	S16-861	Expansion valve	TXV 068Z3347	SET	1	
28	S19-004	Microcomb Wind deflector		SET	2	
29	S19-718	LED light		PCS	1	
30	S21-293	LED light	L=1000	PCS	4	
31	S21-314	LED extrusion	L=0870M	PCS	4	
32	S21-327	Hinge	50X50MM	PCS	6	
33	S21-333	Coaming pipe	20X1/2"	PCS	1	
34	S21-334	PVC pipe	D220	PCS	0.05	
35	S21-515	DC power supply	HM100-0120R33-10700	PCS	1	
36	S21-520	DM Filter	HT170-10-16-63	PCS	1	
37	S21-624	Adjustable Gasior	2"	PCS	4	
38	S21-651	Right blind		PCS	1	
39	S21-664	Slide glass		PCS	2	
40	S21-681	Top glass		PCS	1	
41	S21-682	Glass of shelf (top)		PCS	1	
42	S21-684	Glass of shelf (bottom)		PCS	1	
43	CA53021	Crossbeam of shelf-right		PCS	1	
44	CA53022	Crossbeam of shelf-left		PCS	1	
45	CA53019	Crossbeam of shelf-right		PCS	1	
46	CA53020	Crossbeam of shelf-left		PCS	1	

Cossiga P93-056 BTGR12